

# PLANS PREPARED FOR THE CITY OF WEST PARK

## COUNTYLINE ROAD PHASE 1 IMPROVEMENTS



### INDEX OF ROADWAY PLANS

SHEET NO.	SHEET DESCRIPTION
1	KEY SHEET
2	SUMMARY OF PAY ITEMS
3	TYPICAL SECTION
4	GENERAL NOTES
5 - 6	ROADWAY PLAN & PROFILE
7	MISCELLANEOUS DETAILS
8 - 9	CROSS SECTIONS
10 - 11	SELECTIVE CLEARING & GRUBBING PLAN
12 - 13	STORM WATER POLLUTION PREVENTION PLAN
14 - 15	SIGNING AND PAVEMENT MARKING PLANS
BS - 1	BIOSWALE PLAN
GR-1*	BORING LOCATION PLAN
GR-2*	ROADWAY SOIL PROFILES
GR-3*	ROADWAY SOIL SURVEY

\* THIS SHEET IS INCLUDED IN THE INDEX OF ROADWAY PLANS ONLY TO INDICATE THAT IT IS PART OF THE ROADWAY PLANS. THIS SHEET IS CONTAINED IN A SEPARATE DIGITALLY SIGNED AND SEALED DOCUMENT.

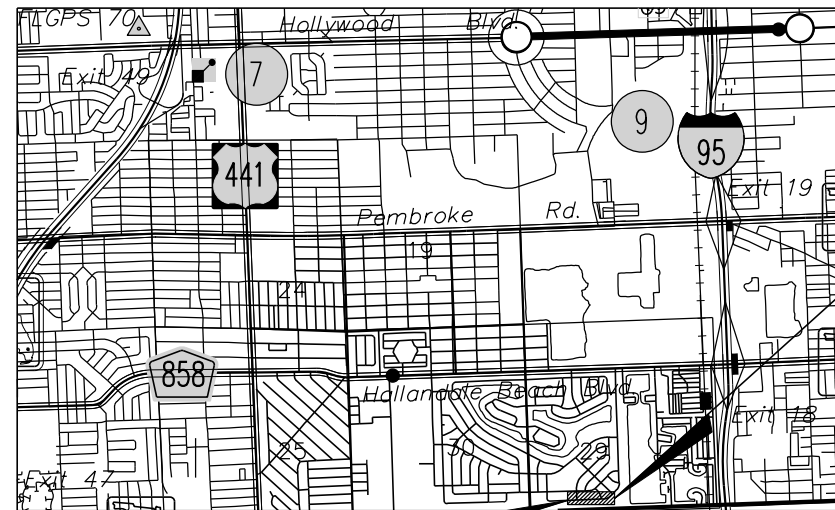
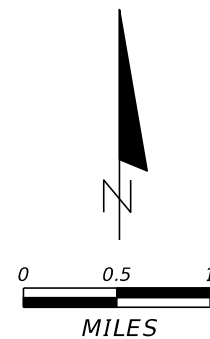

BEGIN PROJECT  
STA. 10+70.00

END PROJECT  
STA. 16+07.50

100%  
SUBMITTAL  
JULY 2023

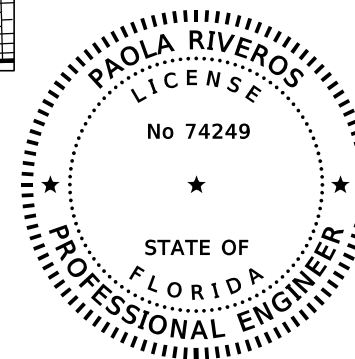

ROADWAY SHOP DRAWINGS  
TO BE SUBMITTED TO:

PAOLA RIVEROS, P.E. No. 74249  
R.J. BEHAR & COMPANY, INC.  
6861 SW 196 AVENUE, SUITE 302  
PEMBROKE PINES, FLORIDA 33332  
Ph: (954) 680-7771 Fax: (954) 680-7781

PLANS PREPARED BY:



**R.J. Behar**

R.J. Behar & Company, Inc.  
6861 SW 196 Avenue, Suite 302  
Pembroke Pines, Florida 33332  
Phone: (954) 680-7771  
Fax: (954) 680-77818365



NOTE: THE SCALE OF THESE PLANS MAY HAVE CHANGED DUE TO REPRODUCTION.

THIS ITEM HAS BEEN DIGITALLY SIGNED AND SEALED BY

ON THE DATE ADJACENT TO THE SEAL  
PRINTED COPIES OF THIS DOCUMENT ARE NOT CONSIDERED SIGNED AND SEALED AND THE SIGNATURE MUST BE VERIFIED ON ANY ELECTRONIC COPIES.

ROADWAY PLANS  
ENGINEER OF RECORD: PAOLA RIVEROS, P.E.

FLORIDA LICENSE NO.: 74249

NOTE: THE SCALE OF THIS PLANS MAY HAVE CHANGE DUE TO REPRODUCTION.

#### GOVERNING STANDARDS AND SPECIFICATIONS:

BROWARD COUNTY MINIMUM STANDARDS 2005 AND THE LATEST CITY OF WEST PARK DESIGN STANDARDS AND SPECIFICATIONS, AS AMENDED BY THE CONTRACT DOCUMENTS.

MANUAL OF UNIFORM MINIMUM STANDARDS FOR DESIGN, CONSTRUCTION, AND MAINTENANCE FOR STREETS & HIGHWAYS - STATE OF FLORIDA.

KEY SHEET REVISIONS	
DATE	DESCRIPTION

PROJECT MANAGER: GREG PERRY P.E., CITY ENGINEER

SHEET NO.  
/

THE OFFICIAL RECORD OF THIS SHEET IS THE ELECTRONIC FILE DIGITALLY SIGNED AND SEALED UNDER RULE 61G15-23.004, F.A.C.

ITEM	DESCRIPTION	UNIT	TOTAL
101-1	MOBILIZATION	LS	1
102-1	MAINTENANCE OF TRAFFIC	LS	1
104-18	INLET PROTECTION SYSTEM	EA	4
110-1-1	CLEARING & GRUBBING	AC	0.497
110-2-2	SELECTIVE CLEARING & GRUBBING	AC	0.019
110-21	TREE PROTECTION BARRIER	LF	351
120-1	REGULAR EXCAVATION	CY	466
120-6	EMBANKMENT	CY	3
160-4	TYPE B STABILIZATION, LBR-40, 12"	SY	1,635
285-709	OPTIONAL BASE, BASE GROUP 09, 10" LIMEROCK BASE OPTION	SY	1,433
334-1-13	SUPERPAVE ASPHALTIC CONCRETE, TRAFFIC C SP-12.5 (2")	TN	155.0
337-7-82	ASPHALT CONCRETE FRICTION COURSE, TRAFFIC C, FC-9.5, PG 76-22 (1")	TN	77.0
520-1-10	CONCRETE CURB & GUTTER, TYPE F	LF	498
570-1-2	PERFORMANCE TURF, SOD (ST. AUGUSTINE) (INC. GRADING)	SY	575
570-A*	BIOSWALE	LF	460
570-B*	PLANT MIX	EA	1,275
706-1-7	RAISED PAVEMENT MARKER, TYPE B	EA	26
711-16-101	THERMOPLASTIC, STD, OTHER SURFACES, WHITE, SOLID, 6"	GM	0.197
711-16-201	THERMOPLASTIC, STD, OTHER SURFACE, YELLOW, SOLID, 6"	GM	0.188

\* NOT A DOT PAY ITEM

PAY ITEM NOTES

520-1-10 - INCLUDES THE FLUMES

570-A - INCLUDES EXCAVATION & DISPOSAL, FURNISHING, INSTALLATION/BACKFILLING, AND GRADING OF ALL SPECIFIED MATERIALS SUCH AS SOIL MIX, DRAIN ROCK, AND FILTER FABRIC IN PREPARATION FOR PLANTS AND SOD.

570-B - INCLUDES MULCH LAYER, TICKSEED, BLUE-EYED GRASS AND MUHLY GRASS.

REVISIONS						<b>R.J. Behar &amp; Company, Inc.</b> Engineers • Planners 6861 S.W. 196 AVENUE, SUITE 302 PEMBROKE PINES, FL 33332 PAOLA RIVEROS, P.E. LICENSE NO. 74249	<b>CITY OF WEST PARK</b>		<b>SUMMARY OF PAY ITEMS</b>	SHEET NO.
DATE	BY	DESCRIPTION	DATE	BY	DESCRIPTION		PROJECT NAME	RJB PROJECT NO.		2
							Countyline RD	23029		

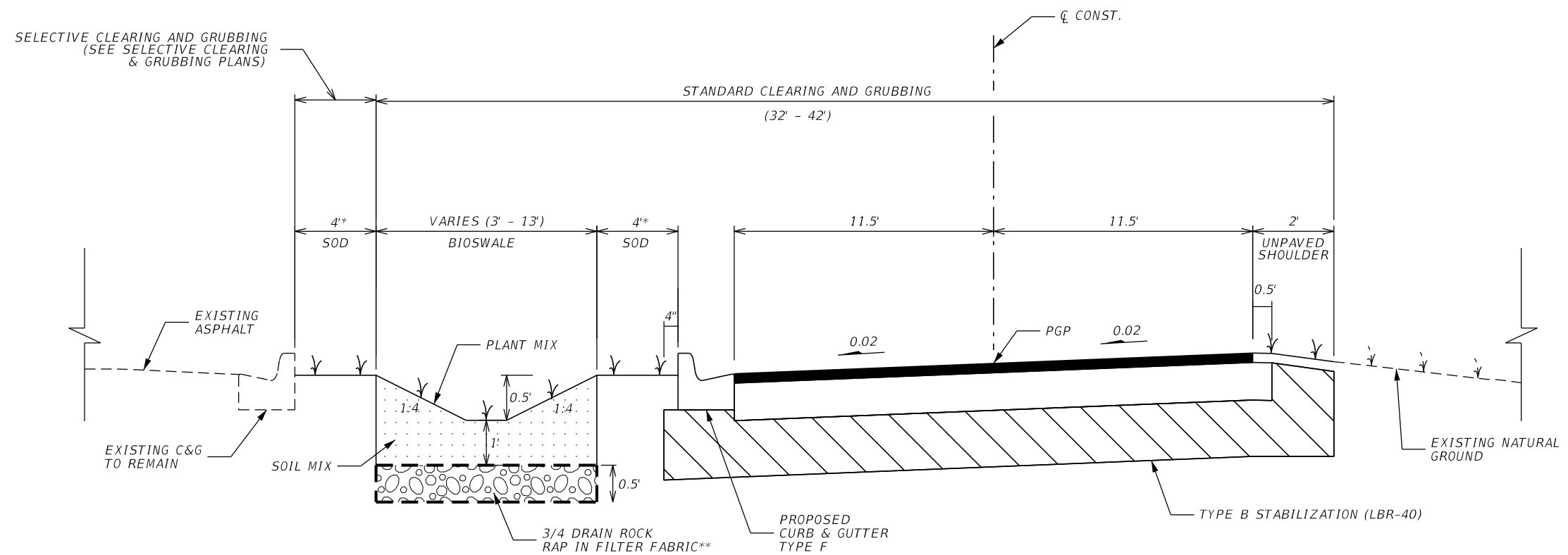

\* SOD MEASUREMENTS COULD VARY AS DIRECTED BY CITY ENGINEER.

\*\* TO BE PLACED AS DIRECTED BY CITY ENGINEER

**RECONSTRUCTION**

12" TYPE B STABILIZATION (LBR-40)  
 OPTIONAL BASE GROUP 9 (10" LIMEROCK BASE) WITH  
 TYPE SP ASPHALTIC CONCRETE STRUCTURAL COURSE, TRAFFIC C (2")  
 ASPHALTIC FRICTION COURSE, TRAFFIC C, FC-9.5 (1")

REVISIONS						R.J. Behar & Company, Inc. Engineers • Planners 6861 S.W. 196 AVENUE, SUITE 302 PEMBROKE PINES, FL 33332 PAOLA RIVEROS, P.E. LICENSE NO. 74249	CITY OF WEST PARK		SHEET NO. 3
DATE	BY	DESCRIPTION	DATE	BY	DESCRIPTION		PROJECT NAME	RJB PROJECT NO.	
						Countyline RD	23029	TYPICAL SECTION	

- ALL PUBLIC LAND CORNERS AND PRIMARY NETWORK CONTROL SURVEY MONUMENTS ARE TO BE PROTECTED BY THE CONTRACTOR. CORNERS AND MONUMENTS WITHIN THE WORK ZONE OR THAT ARE IN DANGER OF BEING DAMAGED SHALL BE PROPERLY REFERENCED BY A REGISTERED LAND SURVEYOR IN ACCORDANCE WITH THE MINIMUM TECHNICAL STANDARDS OF THE FLORIDA BOARD OF PROFESSIONAL LAND SURVEYORS PRIOR TO THE BEGINNING OF CONSTRUCTION. UPON PROJECT COMPLETION, THE CONTRACTOR SHALL RESTORE ALL SUCH CORNERS AND MONUMENTS AND SHALL PROVIDE THE LOCAL DISTRICT OR CITY SURVEYOR WITH A SIGNED AND SEALED COPY OF THE LAND SURVEYOR'S REFERENCE DRAWING. INCLUDE ALL COSTS FOR REFERENCING, RESTORING AND PRESERVING EXISTING CORNERS AND MONUMENTS IN THE BID PRICE FOR MOBILIZATION.
- FOR VERTICAL CONTROL, ALL ELEVATIONS SHOWN HEREIN ARE BASED ON THE NORTH AMERICAN VERTICAL DATUM OF 1988 (NAVD 88').
- THE CONTRACTOR SHALL MAINTAIN VISIBLE STATION MARKS ALONG THE ENTIRE CORRIDOR UNTIL FINAL INSPECTION. THIS COST SHALL BE INCLUDED WITHIN THE MAINTENANCE OF TRAFFIC PAY ITEM.
- ALL EXISTING UTILITIES AND DRAINAGE STRUCTURES ARE TO REMAIN UNLESS OTHERWISE NOTED.
- TWO FULL BUSINESS DAYS PRIOR TO DIGGING THE CONTRACTOR SHALL CALL SUNSHINE 811 AND THE UTILITY OWNERS AND REQUEST UTILITY LOCATIONS. A CONTRACTOR'S REPRESENTATIVE MUST BE PRESENT WHEN UTILITY COMPANIES LOCATE THEIR FACILITIES. CONTRACTOR SHALL LOCATE EXISTING UTILITIES AND INFORM THE CITY OF WEST PARK IF A UTILITY IS IN CONFLICT WITH PROPOSED CONSTRUCTION.

UTILITIES OWNERS:	CONTACT	TELEPHONE
AT&T DISTRIBUTIONS	OTIS KEEVE	954-723-2540
BROWARD COUNTY OES-WATER	SILVIA FIGUEIREDO	954-831-0917
COMCAST CABLE	RICARDO DAVIDSON	954-447-8405
CROWN CASTLE	DAVID ANTOL	724-416-2180
FLORIDA CITY GAS	GUSTAVO PENA	305-986-0902
FPL BROWARD	JOEL BRAY	305-378-2634
FPL DADE	EDGAR AGUILAR	305-378-2634
MIAMI DADE WASD	MARIA CAPOTE	786-268-5329
TOWN OF PEMBROKE PARK	ROBERT CLARK	954-966-4600
VERIZON / MCI	CARR DONOVAN	954-213-1959
WINDSTREAM COMMUNICATIONS	LISA A. ZINGULA	800-289-1901

- THE CONTRACTOR IS ADVISED THAT PROPERTIES ADJACENT TO THE PROJECT HAVE ELECTRIC, TELEPHONE, GAS, WATER AND/OR SEWER SERVICE LATERALS, WHICH MAY NOT BE SHOWN IN THE PLANS. THE CONTRACTOR MUST REQUEST THE LOCATION OF THESE LATERAL SERVICES FROM THE UTILITY COMPANIES. THE ADDITIONAL COST OF EXCAVATING, INSTALLING, BACKFILLING AND COMPACTING AROUND THESE LATERAL SERVICES MUST BE INCLUDED IN THE BID RELATED ITEM FOR THE WORK BEING DONE.
- CONTRACTOR SHALL FIELD VERIFY AND IF NECESSARY, ADJUST ALL EXISTING MANHOLES, WATER VALVES, SEWER VALVES, METER BOXES, CLEANOUTS ETC. WITHIN THE PROJECT LIMITS TO THE FINAL ROADWAY ELEVATIONS PRIOR TO COMMENCING THE FINAL PAVING OPERATIONS, EVEN IF NOT INDICATED IN THE PLANS.

- EXCAVATED AREAS IN WHICH EXISTING UTILITIES ARE ENCOUNTERED ARE TO BE BACKFILLED WITH FLOWABLE FILL OR OTHER MATERIAL AS DESIGNATED BY THE CITY ENGINEER. LARGE CHUNKS OF EXCAVATED MATERIAL SHALL BE REPLACED WITH SUITABLE MATERIAL OR PROCESSED TO BE MADE SUITABLE FOR BACKFILLING. COST TO BE INCLUDED IN RELATED BID ITEMS.
- ALL EXCESS MATERIAL AS DESIGNATED BY THE CITY'S CONSTRUCTION ENGINEER IS TO BE DISPOSED BY THE CONTRACTOR IN DESIGNATED AREAS WITHIN 48 HOURS OF BEING DEPOSITED WITHIN THE WORK ZONE AT THE CONTRACTOR'S EXPENSE.
- THE CONTRACTOR SHALL USE A STREET SWEEPER (USING WATER AS REQUIRED) OR OTHER EQUIPMENT CAPABLE OF CONTROLLING AND REMOVING DUST. APPROVAL OF THE USE OF SUCH EQUIPMENT IS CONTINGENT UPON ITS DEMONSTRATED ABILITY TO THE PERFORM THE WORK. CLEANING AND SWEEPING IS TO BE INCLUDED WITHIN THE MAINTENANCE OF TRAFFIC PAY ITEM.2.
- THE CONTRACTOR SHALL INSTALL APPROVED PROTECTIVE DEVICES AT ALL DRAINAGE INLETS TO PREVENT MILLED MATERIAL AND SEDIMENT FROM ENTERING THE DRAINAGE SYSTEM. ALL PROTECTIVE DEVICES SHALL BE REMOVED AT THE COMPLETION OF THE PROJECT. THE CONTRACTOR IS RESPONSIBLE FOR KEEPING THE EXISTING AND NEW DRAINAGE STRUCTURES FREE OF SILT, LIMEROCK, AND DEBRIS, ETC, DURING CONSTRUCTION AT NO ADDITIONAL COST.
- OUTSIDE OF THE CLEARING AND GRUBBING LIMITS SHOWN ON THE PLANS, THE CONTRACTOR SHALL PERFORM SELECTIVE CLEARING AND GRUBBING FOR THE WORK BEING DONE AS APPROVED BY THE CITY'S CONSTRUCTION ENGINEER. COST TO BE INCLUDED IN CLEARING AND GRUBBING.
- THE CONTRACTOR SHALL PERFORM AN INVENTORY OF ALL EXISTING STREET LIGHTING, TRAFFIC SIGNAL FACILITIES AND OTHER ELECTRIC AND COMMUNICATION INSTALLATIONS (POLES, PULL BOXES, CONTROLLER CABINETS, SERVICE POINTS, ETC.) WITHIN THE AFFECTED LIMITS. AFFECTED LIMITS INCLUDE ALL AREAS WHERE CLEARING AND GRUBBING, EXCAVATION, REMOVAL OF SIDEWALK, OR ANY SPECIFIED ELECTRICAL RELATED COMPONENTS ARE BEING IMPACTED. THE CONTRACTOR SHALL SUBMIT A REPORT OF THE CONDITION OF EACH INSTALLATION AND ITS CONTENT TO THE CITY'S CONSTRUCTION ENGINEER PRIOR TO THE BEGINNING OF CONSTRUCTION; INCLUDING PHOTOGRAPHS OF ANY IDENTIFIED DEFICIENCIES.
- THE CONTRACTOR SHALL REPAIR ALL DAMAGED PULL BOXES AND THEIR CONTENT IN ACCORDANCE WITH THE LATEST NATIONAL ELECTRICAL CODE REQUIREMENTS. ALL DAMAGED CABLES AND CONDUCTORS SHALL BE REPLACED, NO SPLICES ARE ALLOWED.
- ALL DISTURBED AREAS, INCLUDING PAVEMENT MARKINGS AND SIGNS, SHALL BE RESTORED AT THE CONTRACTOR'S EXPENSE, TO ORIGINAL CONDITION OR BETTER AS STATED IN THE BROWARD COUNTY MINIMUM STANDARDS.
- EXISTING DRAINAGE INLETS, MANHOLES AND STORM SEWERS SHALL REMAIN UNLESS OTHERWISE NOTED. COST OF REMOVAL, DISPOSAL, BACKFILLING AND COMPACTING SHALL BE INCLUDED IN THE CLEARING AND GRUBBING PAY ITEM.
- ALL WORK SHALL BE PERFORMED FROM AND WITHIN THE PUBLIC R/W UNLESS OTHERWISE SPECIFIED WITHIN THE PLAN SET.
- THE CONTRACTOR SHALL REVIEW ENVIRONMENTAL REQUIREMENTS OF ANY PROPOSED STAGING AREAS WITH THE CITY'S ENVIRONMENTAL REPRESENTATIVE AT LEAST SEVENTY-TWO (72) HOURS PRIOR TO USE.

- THE CONTRACTOR SHALL COORDINATE THE SELECTION AND REVIEW OF ANY PROPOSED STAGING AREAS ASSOCIATED WITH THIS PROJECT WITH THE CITY OF WEST PARK PRIOR TO MOBILIZING.
- CONTRACTOR SHALL NOT STAGE OR OPERATE EQUIPMENT WITHIN THE DRIPLINE OF TREES.
- ANY MATERIAL TO BE STOCKPILED FOR PERIODS GREATER THAN 24 HOURS SHALL BE PROTECTED BY APPROPRIATE EROSION CONTROL
- THE CONTRACTOR SHALL NOT BRING ANY HAZARDOUS MATERIALS ONTO THE PROJECT SITE. SHOULD SUCH MATERIALS BE REQUIRED FOR PERFORMING THE CONTRACTED WORK, THE CONTRACTOR SHALL REQUEST, IN WRITING, WRITTEN PERMISSION FROM THE CITY'S CONSTRUCTION ENGINEER. THE CONTRACTOR SHALL PROVIDE A COPY OF THE REQUEST TO THE CITY OF WEST PARK. THE CONTRACTOR SHALL PROVIDE THE CITY WITH A COPY OF THE MATERIAL SAFETY DATA SHEET (MSDS) FOR EACH HAZARDOUS MATERIAL PROPOSED FOR USE AND PROVIDE A DESCRIPTION OF THE INTENDED USE. THE CITY'S CONSTRUCTION ENGINEER SHALL COORDINATE WITH THE CITY PRIOR TO ISSUING WRITTEN APPROVAL TO THE CONTRACTOR. STATE LAW DOES NOT TREAT PETROLEUM PRODUCTS THAT ARE PROPERLY CONTAINERIZED AS HAZARDOUS MATERIALS, THEREFORE, SUCH PRODUCTS DO NOT REQUIRE AN MSDS SUBMITTAL. ALL BULK PETROLEUM PRODUCTS STORED ON SITE SHALL REQUIRE PROPER STORAGE WHICH INCLUDES SECONDARY CONTAINMENT.
- THE CONTRACTOR SHALL ASSIST THE CITY AND/OR ITS REPRESENTATIVES WITH THE HANDLING OF PUBLIC INFORMATION MATERIALS, INCLUDING RESIDENT NOTIFICATION HANDOUTS/LETTERS AND PROJECT CONSTRUCTION SIGNS (IF NECESSARY) PRIOR TO THE START OF EACH SIGNIFICANT PHASE OF CONSTRUCTION. COST OF THIS WORK SHALL BE INCLUDED WITHIN THE MAINTENANCE OF TRAFFIC PAY ITEM.
- BROWARD COUNTY TRAFFIC ENGINEERING DIVISION'S REVIEW DOES NOT INCLUDE A REVIEW AND ACCEPTANCE OF THE PROJECT'S DESIGN OR OPERATION. THESE ITEMS ARE TO BE REVIEWED AND APPROVED BY THE CITY ENGINEER.
- BROWARD COUNTY TRAFFIC ENGINEERING DIVISION DOES NOT REVIEW AND APPROVE, OR INSPECT AND ACCEPT THE FOLLOWING ITEMS FOR MAINTENANCE: PAVEMENT MARKINGS.
- THE CITY ENGINEER IS RESPONSIBLE FOR THE REVIEW AND APPROVAL OF THE DESIGN AND OPERATION OF THE PROJECT, AND FOR THE INSPECTION AND ACCEPTANCE OF THE FOLLOWING ITEMS THAT WILL BE MAINTAINED BY THE CITY: PAVEMENT MARKINGS, AND BIOSWALE ELEMENTS.

REVISIONS

DATE	BY	DESCRIPTION	DATE	BY	DESCRIPTION

**R.J. Behar & Company, Inc.**  
 Engineers • Planners  
 6861 S.W. 196 AVENUE, SUITE 302  
 PEMBROKE PINES, FL 33332  
 PAOLA RIVEROS, P.E. LICENSE NO. 74249

**CITY OF WEST PARK**

PROJECT NAME	RJB PROJECT NO.
Countyline RD	23029

**GENERAL NOTES**

SHEET NO.  
4

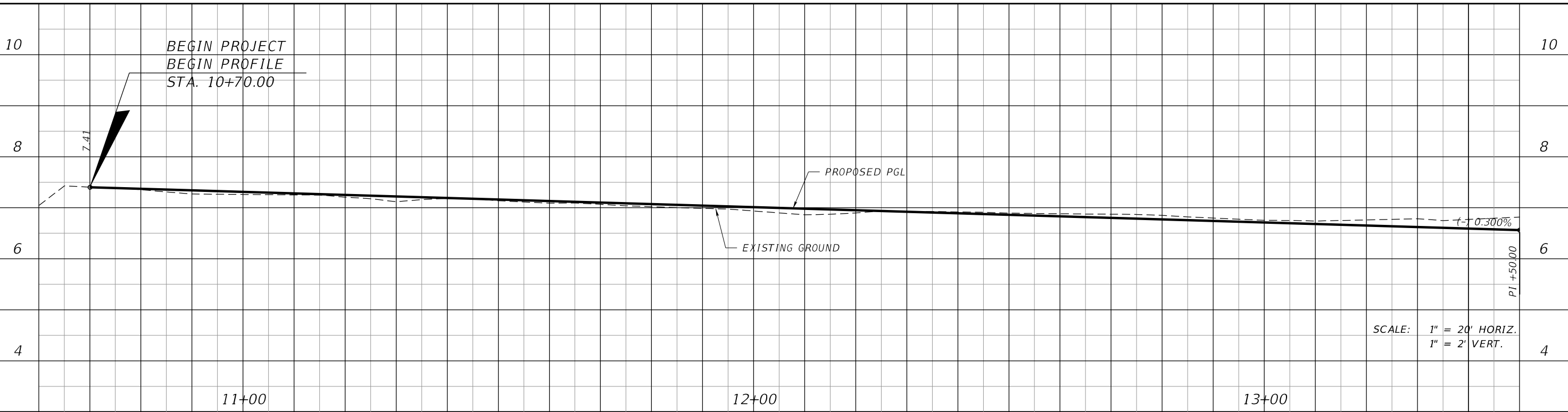
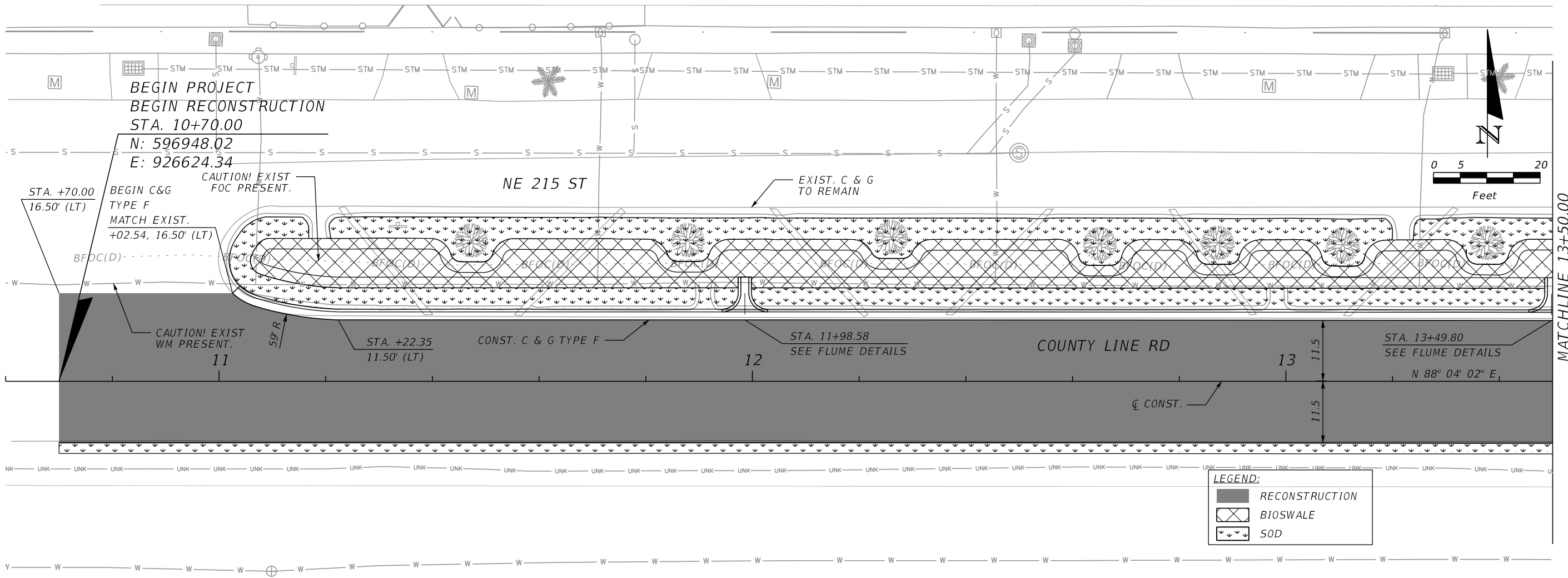

REVISIONS					
DATE	BY	DESCRIPTION	DATE	BY	DESCRIPTION

**R.J. Behar & Company, Inc.**  
 Engineers • Planners  
 6861 S.W. 196 AVENUE, SUITE 302  
 PEMBROKE PINES, FL 33332  
 PAOLA RIVEROS, P.E. LICENSE NO. 74249

**CITY OF WEST PARK**

PROJECT NAME	RJB PROJECT NO.
Countyline RD	23029

**ROADWAY  
 PLAN & PROFILE**

SHEET NO.  
 5

THE OFFICIAL RECORD OF THIS SHEET IS THE ELECTRONIC FILE DIGITALLY SIGNED AND SEALED UNDER RULE 61G15-23.004, F.A.C.

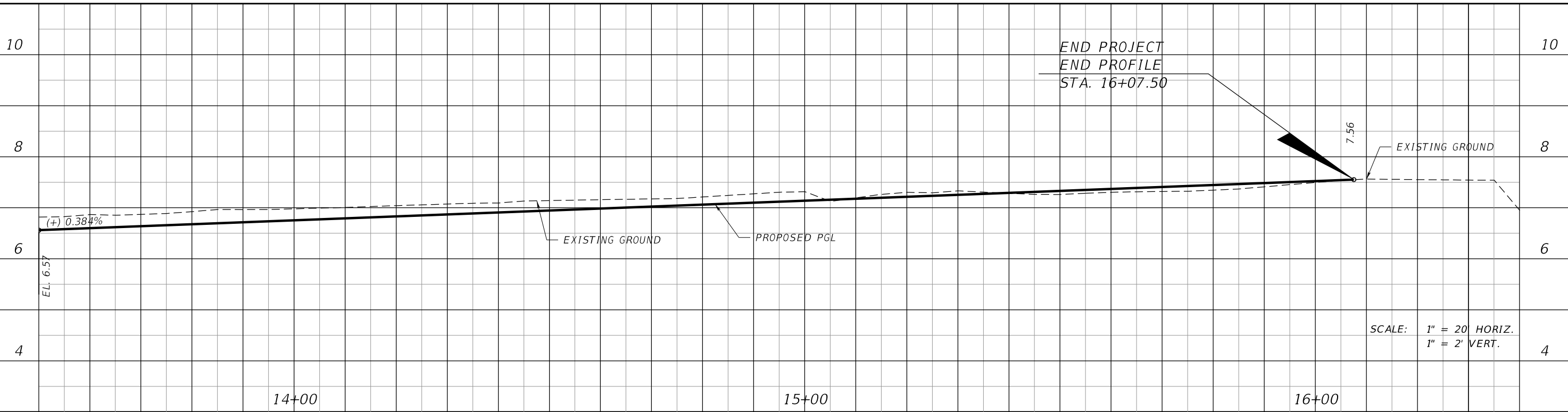
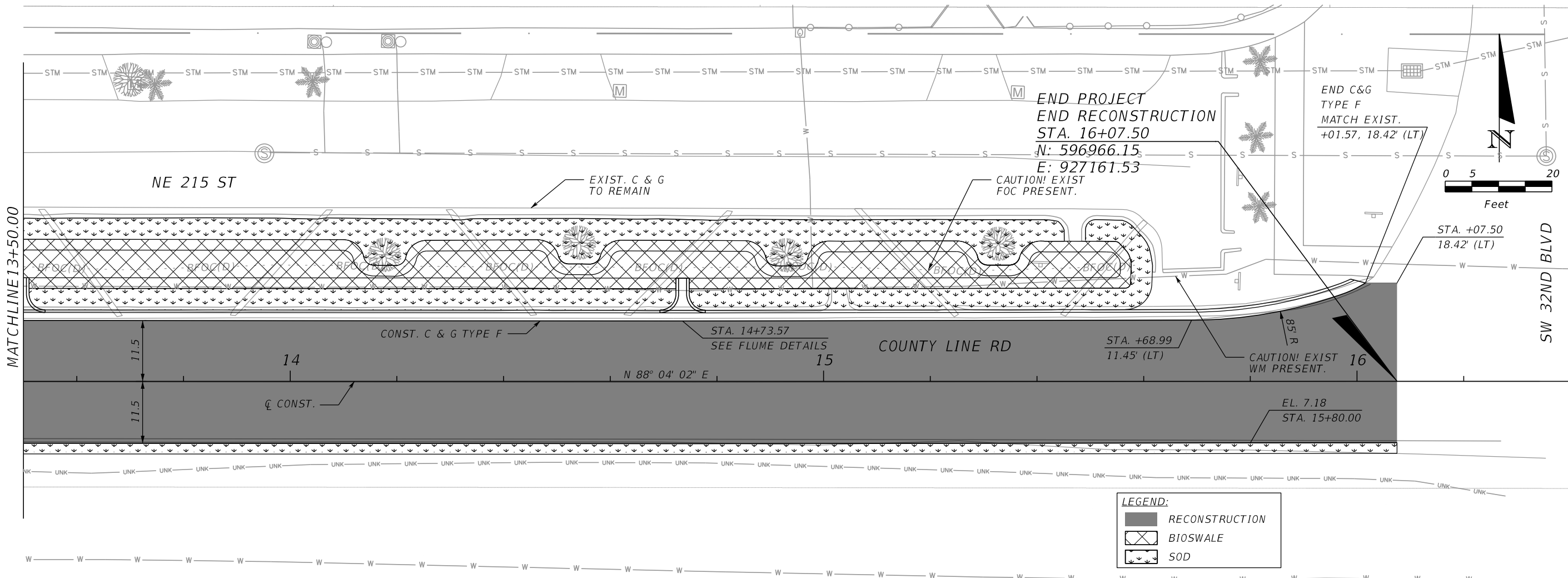

REVISIONS						R.J. Behar & Company, Inc. Engineers • Planners 6861 S.W. 196 AVENUE, SUITE 302 PEMBROKE PINES, FL 33332 PAOLA RIVEROS, P.E. LICENSE NO. 74249	CITY OF WEST PARK		ROADWAY PLAN & PROFILE	SHEET NO.
DATE	BY	DESCRIPTION	DATE	BY	DESCRIPTION		PROJECT NAME	RJB PROJECT NO.		
							Countyline RD	23029		

THE OFFICIAL RECORD OF THIS SHEET IS THE ELECTRONIC FILE DIGITALLY SIGNED AND SEALED UNDER RULE 61G15-23.004, F.A.C.

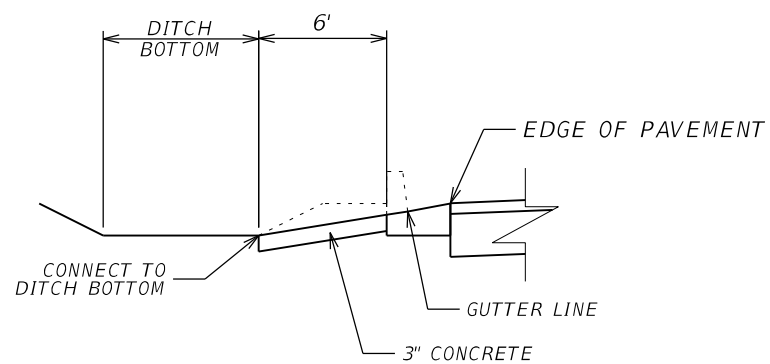

**SECTION A-A**  
N.T.S.

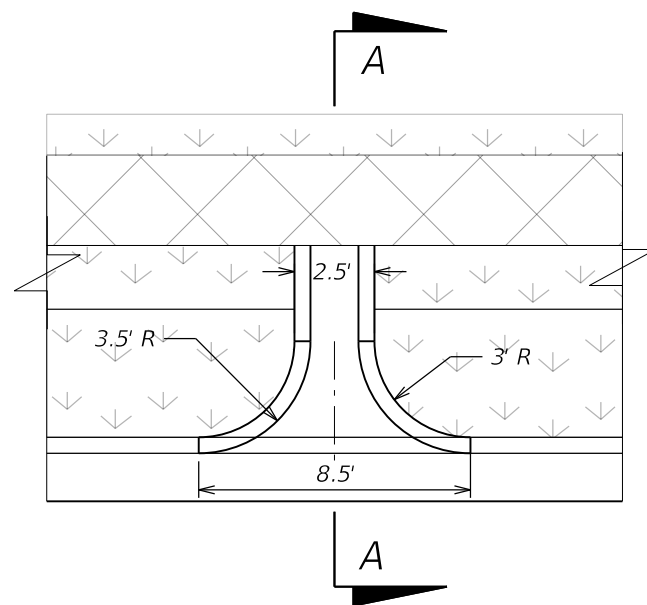

**FLUME DETAIL**  
N.T.S.

REVISIONS					
DATE	BY	DESCRIPTION	DATE	BY	DESCRIPTION

**R.J. Behar & Company, Inc.**  
 Engineers • Planners  
 6861 S.W. 196 AVENUE, SUITE 302  
 PEMBROKE PINES, FL 33332  
 PAOLA RIVEROS, P.E. LICENSE NO. 74249

**CITY OF WEST PARK**

PROJECT NAME	RJB PROJECT NO.
Countyline RD	23029

**MISCELLANEOUS DETAILS**

SHEET NO.
7

14  
12  
10  
8  
6  
4

14  
12  
10  
8  
6  
4

14  
12  
10  
8  
6  
4

6

CONST.

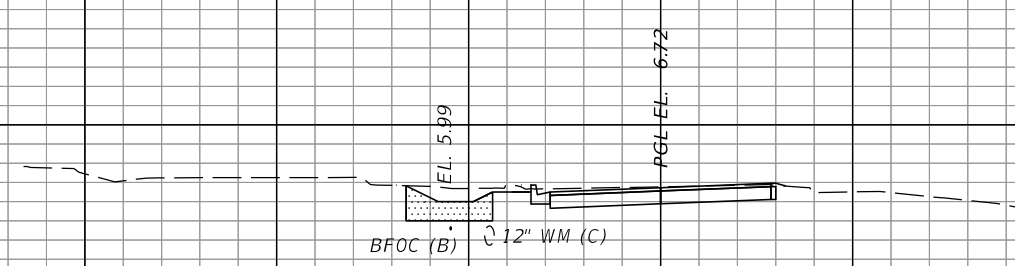

13+00.000

22	79	0	1
----	----	---	---

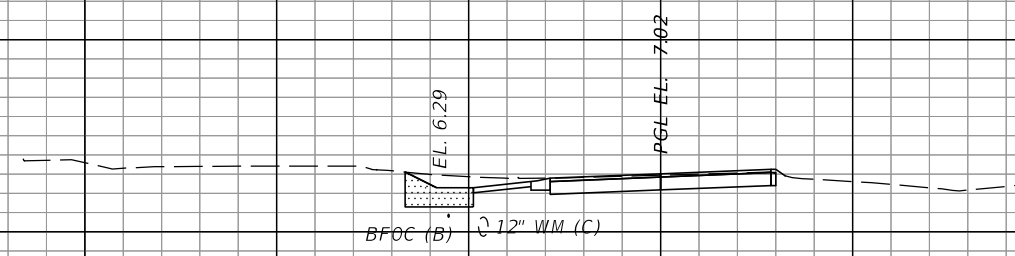

12+00.000

20	80	0	1
----	----	---	---

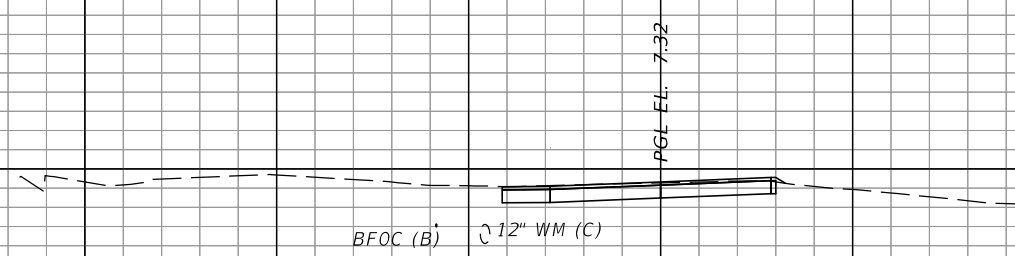

11+00.000

23	26	0	0
----	----	---	---

BEGIN OF PROJECT  
10+70.000

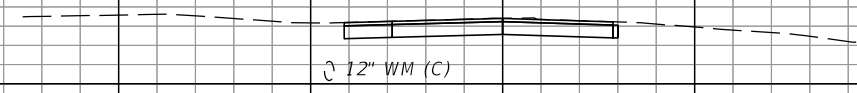

24	0	0	0
----	---	---	---

1" = 20' Horizontal  
1" = 10' Vertical

160 140 120 100 80 60 40 20 0 20 40 60 80 100 120

REVISIONS					
DATE	BY	DESCRIPTION	DATE	BY	DESCRIPTION

**R.J. Behar & Company, Inc.**  
Engineers • Planners  
6861 S.W. 196 AVENUE, SUITE 302  
PEMBROKE PINES, FL 33332  
PAOLA RIVEROS, P.E. LICENSE NO. 74249

**CITY OF WEST PARK**  
PROJECT NAME: Countyline RD  
RJB PROJECT NO.: 23029

**CROSS SECTIONS**

SHEET NO.  
8

THE OFFICIAL RECORD OF THIS SHEET IS THE ELECTRONIC FILE DIGITALLY SIGNED AND SEALED UNDER RULE 61G15-23.004, F.A.C.

EARTHWORK	
TOTALS	(CY)
EXCAVATION	466
FILL (EMBANKMENT)	3

Regular		Exc.		Embankment	
A	V	A	V	A	V
33	8	0	0	0	0
24	88	0	1	0	0
24	94	0	0	0	0
27	91	0	0	0	0

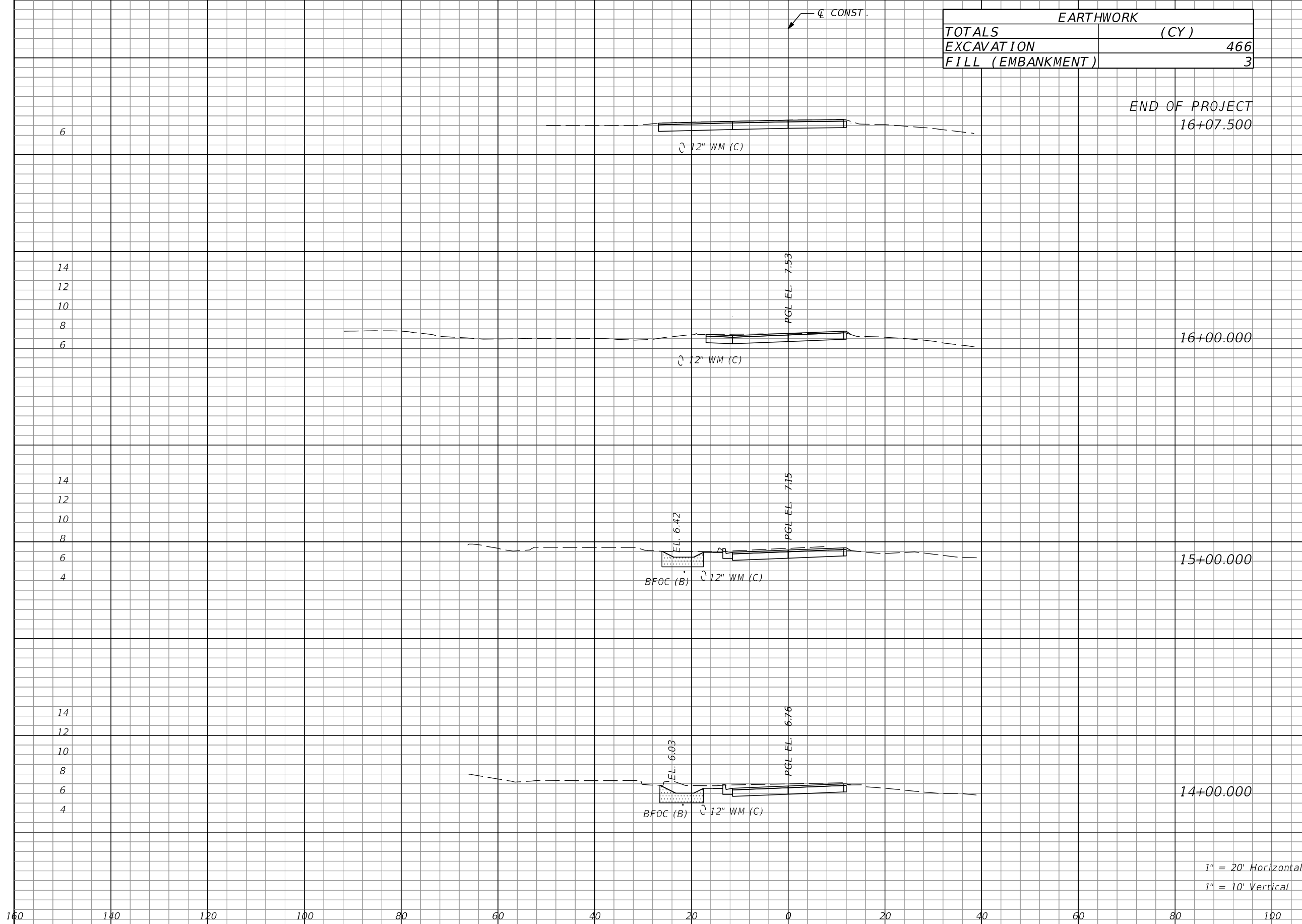

REVISIONS					
DATE	BY	DESCRIPTION	DATE	BY	DESCRIPTION

**R.J. Behar & Company, Inc.**  
 Engineers • Planners  
 6861 S.W. 196 AVENUE, SUITE 302  
 PEMBROKE PINES, FL 33332  
 PAOLA RIVEROS, P.E. LICENSE NO. 74249

**CITY OF WEST PARK**  
 PROJECT NAME: Countyline RD  
 RJB PROJECT NO.: 23029

**CROSS SECTIONS**

SHEET NO.  
9

THE OFFICIAL RECORD OF THIS SHEET IS THE ELECTRONIC FILE DIGITALLY SIGNED AND SEALED UNDER RULE 61G15-23.004, F.A.C.

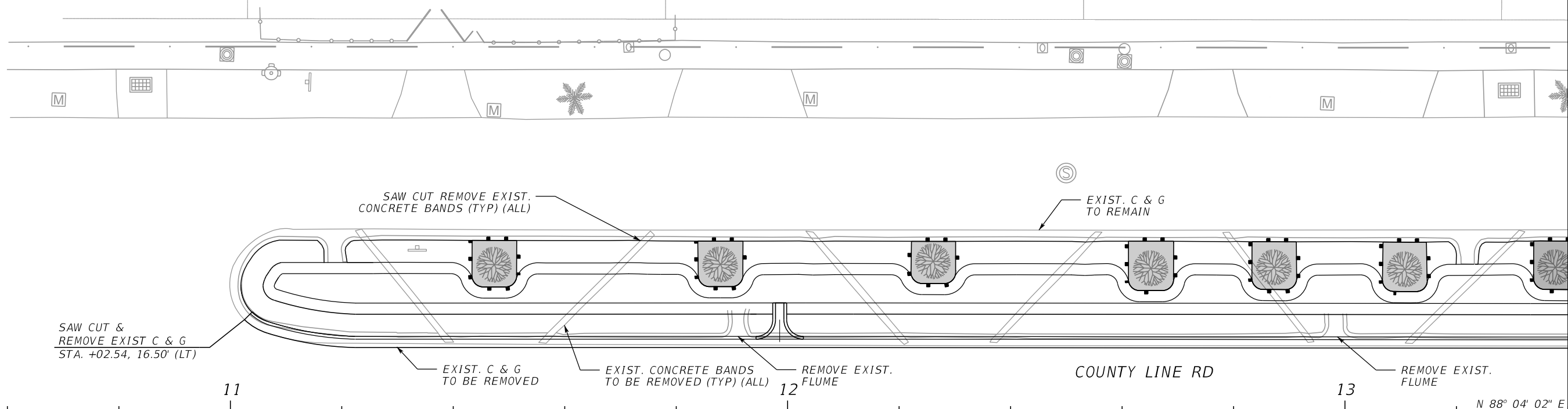

SAW CUT &  
REMOVE EXIST C & G  
STA. +02.54, 16.50' (LT)

SAW CUT REMOVE EXIST.  
CONCRETE BANDS (TYP) (ALL)

EXIST. C & G  
TO REMAIN

11

EXIST. C & G  
TO BE REMOVED

EXIST. CONCRETE BANDS  
TO BE REMOVED (TYP) (ALL)

REMOVE EXIST.  
FLUME

12

COUNTY LINE RD

REMOVE EXIST.  
FLUME

13

N 88° 04' 02" E

☒ CONST.

MATCHLINE 13+40.00

BEGIN PROJECT  
BEGIN RECONSTRUCTION  
STA. 10+70.00



**LEGEND:**

- SELECTIVE CLEARING AND GRUBBING- TREES TO REMAIN
- TREE PROTECTION BARRIER

REVISIONS					
DATE	BY	DESCRIPTION	DATE	BY	DESCRIPTION

**R.J. Behar & Company, Inc.**  
Engineers • Planners  
6861 S.W. 196 AVENUE, SUITE 302  
PEMBROKE PINES, FL 33332  
PAOLA RIVEROS, P.E. LICENSE NO. 74249

<b>CITY OF WEST PARK</b>	
PROJECT NAME	RJB PROJECT NO.
Countyline RD	23029

<b>SELECTIVE CLEARING &amp; GRUBBING PLAN</b>
SHEET NO. <b>10</b>

THE OFFICIAL RECORD OF THIS SHEET IS THE ELECTRONIC FILE DIGITALLY SIGNED AND SEALED UNDER RULE 61G15-23.004, F.A.C.

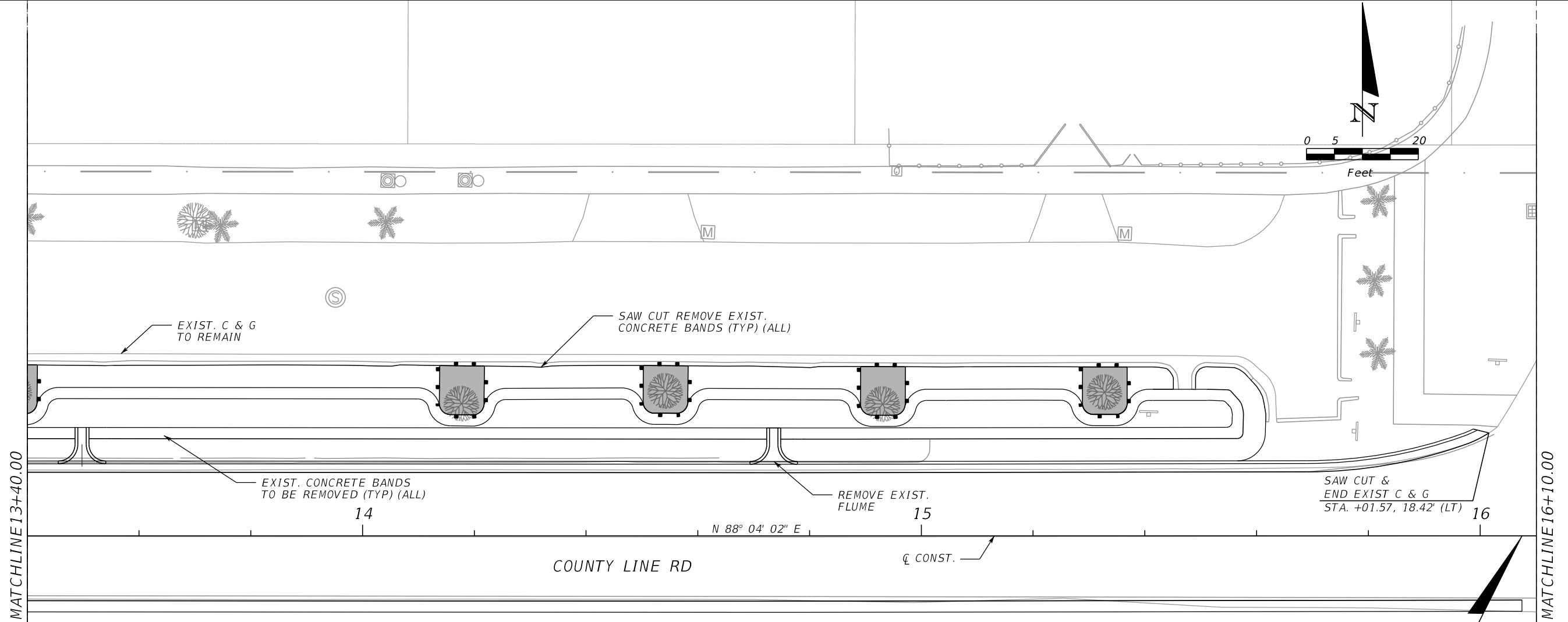
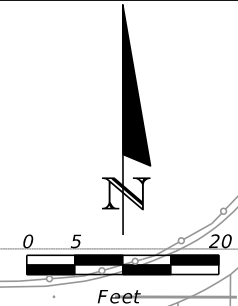

**LEGEND:**

	SELECTIVE CLEARING AND GRUBBING- TREES TO REMAIN
	TREE PROTECTION BARRIER

REVISIONS					
DATE	BY	DESCRIPTION	DATE	BY	DESCRIPTION

**R.J. Behar & Company, Inc.**  
 Engineers • Planners  
 6861 S.W. 196 AVENUE, SUITE 302  
 PEMBROKE PINES, FL 33332  
 PAOLA RIVEROS, P.E. LICENSE NO. 74249

**CITY OF WEST PARK**

PROJECT NAME	RJB PROJECT NO.
Countyline RD	23029

**SELECTIVE CLEARING & GRUBBING PLAN**

SHEET NO.  
11

THE OFFICIAL RECORD OF THIS SHEET IS THE ELECTRONIC FILE DIGITALLY SIGNED AND SEALED UNDER RULE 61G15-23.004, F.A.C.

THE FOLLOWING NARRATIVE OF THE STORMWATER POLLUTION PREVENTION PLAN CONTAINS REFERENCES TO THE FLORIDA STORMWATER EROSION AND SEDIMENTATION CONTROL INSPECTOR'S MANUAL, BROWARD COUNTY PUBLIC WORKS DEPARTMENT MINIMUM STANDARDS AND THESE CONSTRUCTION PLANS. THE FIRST SHEET OF THE CONSTRUCTION PLANS (KEY SHEET) CONTAINS AN INDEX TO THE OTHER SHEETS. THE COMPLETE STORMWATER POLLUTION PREVENTION PLAN INCLUDES SEVERAL ITEMS: THIS NARRATIVE DESCRIPTION, THE DOCUMENTS REFERENCED IN THIS NARRATIVE, THE REQUIRED CONTRACTOR'S EROSION CONTROL PLAN, AND REPORTS OF INSPECTIONS MADE DURING CONSTRUCTION.

**1.0 SITE DESCRIPTION:**

**1.a. NATURE OF CONSTRUCTION ACTIVITY:**

COUNTY LINE ROAD IMPROVEMENTS PROJECT CONSISTS OF FULL ROADWAY RECONSTRUCTION, NEW CURB AND GUTTER TYPE F AND RESHAPE OF EXISTING LANDSCAPED MEDIAN.

**1.b. SEQUENCE OF MAJOR SOIL DISTURBING ACTIVITIES:**

THE CONTRACTOR SHALL PROVIDE A DETAILED SEQUENCE OF CONSTRUCTION FOR ALL CONSTRUCTION ACTIVITIES. THE CONTRACTOR SHALL FOLLOW THE SEQUENCE OF MAJOR ACTIVITIES DESCRIBED BELOW, UNLESS THE CONTRACTOR PROPOSES A DIFFERENT SEQUENCE THAT IS EQUAL OR BETTER AT CONTROLLING EROSION AND TRAPPING SEDIMENT AND IS APPROVED BY THE ENGINEER.

**a. CLEARING & GRUBBING AND EARTHWORK**

b. EARTHWORK ASSOCIATED WITH ROADWAY, CURB AND GUTTER, SUB GRADE, BASE AND PAVEMENT AND SODDING.

**1.c. AREA ESTIMATES:**

TOTAL SITE AREA: 0.52 AC.  
TOTAL AREA TO BE DISTURBED: 0.52 AC.

**1.d. RUNOFF DATA:**

RUNOFF COEFFICIENTS:  
BEFORE: C=0.74  
DURING: C=0.74  
AFTER: C=0.74

SOILS DATA: THE RESULTS OF THE SOIL BORINGS ALONG THE ROADWAY CORRIDOR ARE SHOWN IN THE GEOTECHNICAL REPORT (PREPARED BY AREHNA ENGINEERING, INC.) AND INCLUDED AS PART OF THE CONSTRUCTION DOCUMENTS.

**1.e. SITE MAP:**

THE CONSTRUCTION PLANS ARE BEING USED AS THE SITE MAPS. THE LOCATION OF THE REQUIRED INFORMATION IS DESCRIBED BELOW. THE SHEET NUMBERS FOR THE PLAN SHEETS REFERENCED ARE IDENTIFIED ON THE KEY SHEET OF THESE CONSTRUCTION PLANS.

- \* APPROXIMATE SLOPES: THE SLOPES OF THE SITE CAN BE SEEN IN THE ROADWAY CROSS SECTION SHEETS.
- \* AREAS OF SOIL DISTURBANCE: THE AREAS TO BE DISTURBED ARE INDICATED ON THE ROADWAY PLAN SHEETS AND THE ROADWAY CROSS SECTION SHEETS. ANY AREAS WHERE PERMANENT FEATURES ARE SHOWN TO BE CONSTRUCTED ABOVE OR BELOW THE EXISTING GROUND WILL BE DISTURBED.
- \* AREAS TO BE STABILIZED: AREAS WHERE PERMANENT STABILIZATION IS REQUIRED ARE INDICATED ON THE TYPICAL SECTIONS.
- \* SURFACE WATERS: THERE ARE NO SURFACE WATERS WITHIN THE PROJECT LIMITS.
- \* DISCHARGE POINTS TO SURFACE WATERS: THERE ARE NO SURFACE WATERS WITHIN THE PROJECT LIMITS.

**2.0 CONTROLS:**

**2.a. EROSION AND SEDIMENT CONTROLS:**

IN THE EROSION CONTROL PLAN, THE CONTRACTOR SHALL DESCRIBE THE PROPOSED STABILIZATION AND STRUCTURAL PRACTICES BASED ON THE CONTRACTOR'S PROPOSED TRAFFIC CONTROL PLAN. THE FOLLOWING RECOMMENDED GUIDELINES ARE BASED ON THE TRAFFIC CONTROL PLAN OUTLINED IN THE CONSTRUCTION PLANS. THE CONTRACTOR MAY CHOOSE TO ACCEPT THE FOLLOWING GUIDELINES OR MODIFY THEM IN THE EROSION CONTROL PLAN, SUBJECT TO APPROVAL OF THE ENGINEER. AS WORK PROGRESSES, THE CONTRACTOR SHALL MODIFY THE PLAN TO ADOPT TO SEASONAL VARIATION, CHANGES IN CONSTRUCTION ACTIVITIES AND THE NEED FOR BETTER PRACTICES.

FOR EACH CONSTRUCTION PHASE, INSTALL PERIMETER CONTROLS AFTER CLEARING AND GRUBBING NECESSARY FOR THE INSTALLATION OF THESE CONTROLS BUT BEFORE BEGINNING ANY OTHER WORK WITHIN THE PHASE. REMOVE PERIMETER CONTROLS ONLY AFTER ALL UPSTREAM AREAS ARE STABILIZED.

**MAINTENANCE OF TRAFFIC NARRATIVE:**

REFER TO TRAFFIC CONTROL PLANS AND NOTES. SEE ROADWAY PLANS.

**2.a.1 STABILIZATION PRACTICES:**

IN THE EROSION CONTROL PLAN, THE CONTRACTOR SHALL INITIATE ALL STABILIZATION MEASURES AS SOON AS PRACTICAL, BUT IN NO CASE MORE THAN 7 DAYS BEFORE THE ACTIVITY. IN PORTIONS OF THE SITE WHERE CONSTRUCTION ACTIVITIES HAVE TEMPORARILY OR PERMANENTLY CEASED. THE STABILIZATION PRACTICES SHALL INCLUDE AT LEAST THE FOLLOWING, UNLESS OTHERWISE APPROVED BY THE ENGINEER:

- TEMPORARY:**
- \* ARTIFICIAL COVERINGS
  - \* TURF AND SOD

- PERMANENT:**
- \* ASPHALT OR CONCRETE SURFACE
  - \* SOD

**2.a.2 STRUCTURAL PRACTICES:**

IN THE EROSION CONTROL PLAN, THE CONTRACTOR SHALL DESCRIBE THE PROPOSED STRUCTURAL PRACTICES TO CONTROL OR TRAP SEDIMENT AND OTHERWISE PREVENT THE DISCHARGE OF POLLUTANTS FROM EXPOSED AREAS OF THE SITE. SEDIMENT CONTROLS SHALL BE IN PLACE BEFORE DISTURBING SOIL UPSTREAM OF THE CONTROL. THE STRUCTURAL PRACTICES SHALL INCLUDE AT LEAST THE FOLLOWING, UNLESS OTHERWISE APPROVED BY THE ENGINEER.

- TEMPORARY:**
- \* SILT FENCES AND INLET PROTECTION SYSTEM IN ACCORDANCE WITH THE FLORIDA STORMWATER EROSION AND SEDIMENTATION CONTROL INSPECTOR'S MANUAL.

- PERMANENT:**
- \* SOD

**2.b. STORMWATER MANAGEMENT:**

RUNOFF WILL BE ROUTED, VIA OVERLAND FLOW, TOWARDS EXISTING AND PROPOSED INLETS WHICH CONNECT TO EXISTING INLETS AND PIPES. WATER QUALITY FOR ADDITIONAL IMPERVIOUS AREA WILL BE PROVIDED BY RESHAPING THE EXISTING SWALES. THE DRAINAGE SYSTEMS HAVE BEEN DESIGNED TO COMPLY WITH ALL APPLICABLE DESIGN STANDARDS.

**2.c. OTHER CONTROLS:**

**2.c.1 WASTE DISPOSAL:**

IN THE EROSION CONTROL PLAN, THE CONTRACTOR SHALL DESCRIBE THE PROPOSED METHODS TO PREVENT THE DISCHARGE OF SOLID MATERIALS, INCLUDING BUILDING MATERIALS, SANITARY WASTE AND HAZARDOUS WASTE TO WATERS OF THE UNITED STATES. THE PROPOSED METHODS SHALL INCLUDE AT LEAST THE FOLLOWING, UNLESS OTHERWISE APPROVED BY THE ENGINEER:

- \* PROVIDING LITTER CONTROL AND COLLECTION WITHIN THE PROJECT DURING ALL CONSTRUCTION ACTIVITIES.
- \* DISPOSING OF ALL FERTILIZER OR OTHER CHEMICAL CONTAINERS ACCORDING TO EPA'S STANDARD PRACTICES AS DETAILED BY THE MANUFACTURER.
- \* DISPOSING OF SOLID MATERIALS INCLUDING BUILDING AND CONSTRUCTION MATERIALS OFF THE PROJECT SITE BUT NOT IN SURFACE WATERS, OR WETLANDS.

**2.c.2 OFF-SITE VEHICLE TRACKING & DUST CONTROL:**

IN THE EROSION CONTROL PLAN, THE CONTRACTOR SHALL DESCRIBE THE PROPOSED METHODS FOR MINIMIZING OFF-SITE VEHICLE TRACKING OF SEDIMENTS AND GENERATING DUST. THE PROPOSED METHODS SHALL INCLUDE AT LEAST THE FOLLOWING, UNLESS OTHERWISE APPROVED BY THE ENGINEER:

- \* COVERING LOADED HAUL TRUCKS WITH TARPULINS.
- \* REMOVING EXCESS DIRT FROM ROADS DAILY.
- \* STABILIZING CONSTRUCTION ENTRANCES ACCORDING TO THE FLORIDA STORMWATER EROSION AND SEDIMENTATION CONTROL INSPECTOR'S MANUAL AND BROWARD COUNTY PUBLIC WORKS DEPARTMENT MINIMUM STANDARDS.
- \* USING ROADWAY SWEEPERS DURING DUST GENERATING ACTIVITIES SUCH AS EXCAVATION AND MILLING OPERATIONS.

**2.c.3 STATE AND LOCAL REGULATIONS FOR WASTE DISPOSAL, SANITARY SEWER, OR SEPTIC TANK REGULATIONS:**

IN THE EROSION CONTROL PLAN, THE CONTRACTOR SHALL DESCRIBE THE PROPOSED PROCEDURES TO COMPLY WITH APPLICABLE STATE AND LOCAL REGULATIONS FOR WASTE DISPOSAL, AND SANITARY SEWER OR SEPTIC SYSTEMS.

**2.c.4 FERTILIZERS AND PESTICIDES:**

IN THE EROSION CONTROL PLAN, THE CONTRACTOR SHALL DESCRIBE THE PROCEDURES FOR APPLYING FERTILIZERS AND PESTICIDES.

**2.c.5 TOXIC SUBSTANCES:**

IN THE EROSION CONTROL PLAN, THE CONTRACTOR SHALL PROVIDE A LIST OF TOXIC SUBSTANCES THAT ARE LIKELY TO BE USED ON THE JOB AND PROVIDE A PLAN ADDRESSING THE GENERATION, APPLICATION, MIGRATION, STORAGE, AND DISPOSAL OF THESE SUBSTANCES.

**3.0 MAINTENANCE:**

IN THE EROSION CONTROL PLAN, THE CONTRACTOR SHALL PROVIDE A PLAN FOR MAINTAINING ALL EROSION AND SEDIMENT CONTROLS THROUGHOUT CONSTRUCTION. THE MAINTENANCE PLAN SHALL AT A MINIMUM, COMPLY WITH THE FOLLOWING:

- INLET PROTECTION. THE CONTRACTOR SHOULD REPLACE INLET PROTECTION AS REQUIRED DUE TO DAMAGE.
- SILT FENCE.

REVISIONS						R.J. Behar & Company, Inc. Engineers • Planners 6861 S.W. 196 AVENUE, SUITE 302 PEMBROKE PINES, FL 33332 PAOLA RIVEROS, P.E. LICENSE NO. 74249	CITY OF WEST PARK		STORM WATER POLLUTION PREVENTION PLAN	SHEET NO.
DATE	BY	DESCRIPTION	DATE	BY	DESCRIPTION		PROJECT NAME	RJB PROJECT NO.		
							Countyline RD	23029		

4.0 INSPECTIONS:

QUALIFIED PERSONNEL SHALL INSPECT THE FOLLOWING ITEMS AT LEAST ONCE EVERY SEVEN (7) CALENDAR DAYS AND WITHIN 24 HOURS OF THE END OF A STORM THAT IS 0.50 INCHES OR GREATER. TO COMPLY, THE CONTRACTOR SHALL INSTALL AND MAINTAIN RAIN GAGES AND RECORD THE DAILY RAINFALL. WHERE SITES HAVE BEEN PERMANENTLY STABILIZED, INSPECTIONS SHALL BE CONDUCTED AT LEAST ONCE EVERY MONTH. THE CONTRACTOR SHALL ALSO INSPECT THAT CONTROLS INSTALLED IN THE FIELD AGREE WITH THE LATEST STORMWATER POLLUTION PREVENTION PLAN. THE FOLLOWING, AT A MINIMUM, SHOULD BE INSPECTED WITH THE ABOVE-MENTIONED FREQUENCIES:

- \* POINTS OF DISCHARGE TO WATERS OF THE UNITED STATES.
- \* POINTS OF DISCHARGE TO MUNICIPAL SEPARATE STORM SEWER SYSTEMS.
- \* DISTURBED AREAS OF THE SITE THAT HAVE BEEN FULLY STABILIZED.
- \* AREAS USED FOR STORAGE OF MATERIALS THAT ARE EXPOSED TO PRECIPITATION.
- \* STRUCTURAL CONTROLS.
- \* STORMWATER MANAGEMENT SYSTEMS.
- \* LOCATIONS WHERE VEHICLES ENTER OR EXIT THE SITE.

THE CONTRACTOR SHALL INITIATE REPAIRS WITHIN 24 HOURS OF INSPECTIONS THAT INDICATE ITEMS ARE NOT IN GOOD WORKING ORDER.

IF INSPECTIONS INDICATE THAT THE INSTALLED STABILIZATION AND STRUCTURAL PRACTICES ARE NOT SUFFICIENT TO MINIMIZE EROSION, RETAIN SEDIMENT, AND PREVENT DISCHARGING POLLUTANTS, THE CONTRACTOR SHALL PROVIDE ADDITIONAL MEASURES, AS APPROVED BY THE ENGINEER.

5.0 NON-STORMWATER DISCHARGES

IN THE EROSION CONTROL PLAN, THE CONTRACTOR SHALL IDENTIFY ALL ANTICIPATED NON-STORMWATER DISCHARGES (EXCEPT FLOWS FROM FIRE FIGHTING ACTIVITIES). THE CONTRACTOR SHALL DESCRIBE THE PROPOSED MEASURES TO PREVENT POLLUTION OF THESE NON-STORMWATER DISCHARGES. IF THE CONTRACTOR ENCOUNTERS CONTAMINATED SOIL OR GROUNDWATER, CONTACT THE CITY OF WEST PARK IMMEDIATELY.

6.0 NPDES SUBMITTALS:

THE CONTRACTOR IS RESPONSIBLE FOR SUBMITTING AN EROSION CONTROL PLAN (ECP) TO THE CITY OF WEST PARK FOR REVIEW AND APPROVAL PRIOR TO THE CONTRACTOR'S SUBMITTAL FOR THE FLORIDA DEPARTMENT OF ENVIRONMENTAL PROTECTION (DEP) NATIONAL POLLUTANT DISCHARGE ELIMINATION SYSTEM (NPDES) PERMIT. IF THIS STORMWATER POLLUTION PREVENTION PLAN (SWPPP) IS ADOPTED AS PART OF THE CONTRACTOR'S ECP FOR THE PROJECT, COPIES OF THE SWPPP SHEETS AND OTHER PLAN SHEETS INCLUDED BY REFERENCE SHALL BE INCLUDED WITH THE ECP SUBMITTAL. THE CONTRACTOR MAY ELECT TO SUBMIT A REVISED SWPPP THAT IS IN COMPLIANCE WITH STORMWATER REGULATIONS AT 40 CFR 122.26 (BX14) AND STATE WATER QUALITY STANDARDS.

THE CONTRACTOR SHOULD BE AWARE THAT MODIFICATION OF THE TRAFFIC CONTROL PLANS MAY REQUIRE THE CONTRACTOR TO MODIFY THE SWPPP. THE CONTRACTOR'S MODIFIED SWPPP MUST BE PROVIDED TO THE CITY OF WEST PARK FOR REVIEW PRIOR TO THE DEP APPLICATION SUBMITTAL.

THE NPDES PERMIT APPLICATION SHOULD BE SUBMITTED TO THE DEP THIRTY (30) DAYS BEFORE TO ANY CLEARING AND GRUBBING ACTIVITIES. NO SOIL DISTURBING ACTIVITIES CAN BE CONDUCTED UNTIL THE NPDES PACKAGE HAS BEEN MAILED TO THE FDEP, PROCESSED, AND APPROVED.

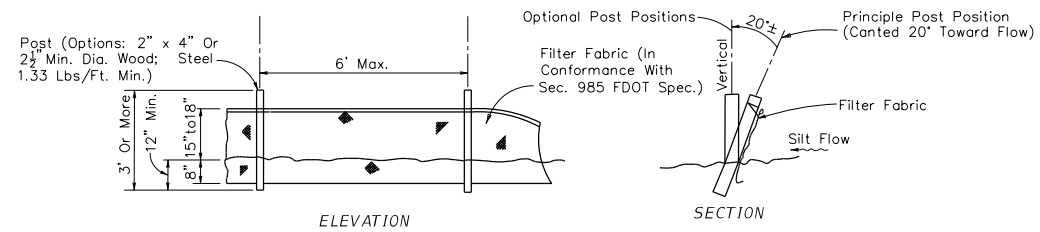

TYPE III SILT FENCE DETAIL  
N.T.S.

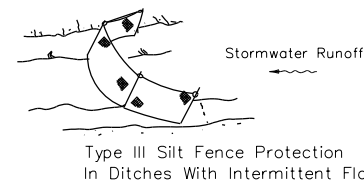

Type III Silt Fence Protection  
In Ditches With Intermittent Flow

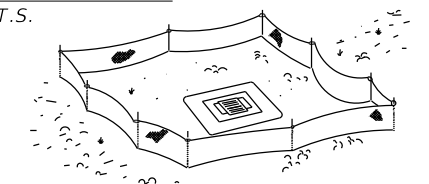

Type III Silt Fence Protection  
Around Ditch Bottom Inlets.

Notes:

1. Spacing for Silt Type III Fence to be in accordance with Chart 1, Sheet 1 of 3 per 2010-FDOT Standard Index 102
2. Do not deploy in a manner that silt fences will act as a dam across permanent flowing watercourses. Silt fences are to be used at upland locations and turbidity barriers used at permanent bodies of water.

SILT FENCE APPLICATIONS  
N.T.S.

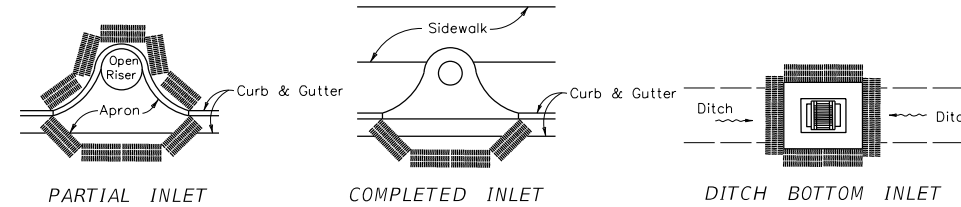

PROTECTION AROUND INLETS OR SIMILAR STRUCTURES  
N.T.S.

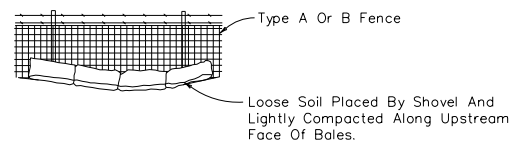

BALES BACKED BY FENCE  
N.T.S.

NOTES FOR SYNTHETIC BALES OR BALE TYPE BARRIERS

1. Type I and II Synthetic Barrier should be spaced in accordance with Chart 1, sheet 1 of 3 per 2010-FDOT Index 102.
2. Bales shall be anchored with 2-1" x 2" (or 1" dia.) x 4' wood stakes. Stakes of other material or shape providing equivalent strength may be used if approved by the Engineer. Stakes other than wood shall be removed upon completion of the project.
3. Rails and posts shall be 2" x 4" wood. Other materials providing equivalent strength may be used if approved by the Engineer.
4. Adjacent bales shall be butted firmly together.
5. Where used in conjunction with silt fence, bales shall be placed on the upstream side of the fence.

REVISIONS						<b>R.J. Behar &amp; Company, Inc.</b> Engineers • Planners 6861 S.W. 196 AVENUE, SUITE 302 PEMBROKE PINES, FL 33332 PAOLA RIVEROS, P.E. LICENSE NO. 74249	<b>CITY OF WEST PARK</b>		<b>STORM WATER POLLUTION PREVENTION PLAN</b>	SHEET NO.
DATE	BY	DESCRIPTION	DATE	BY	DESCRIPTION		PROJECT NAME	RJB PROJECT NO.		13
							Countyline RD	23029		

THE OFFICIAL RECORD OF THIS SHEET IS THE ELECTRONIC FILE DIGITALLY SIGNED AND SEALED UNDER RULE 61G15-23.004, F.A.C.

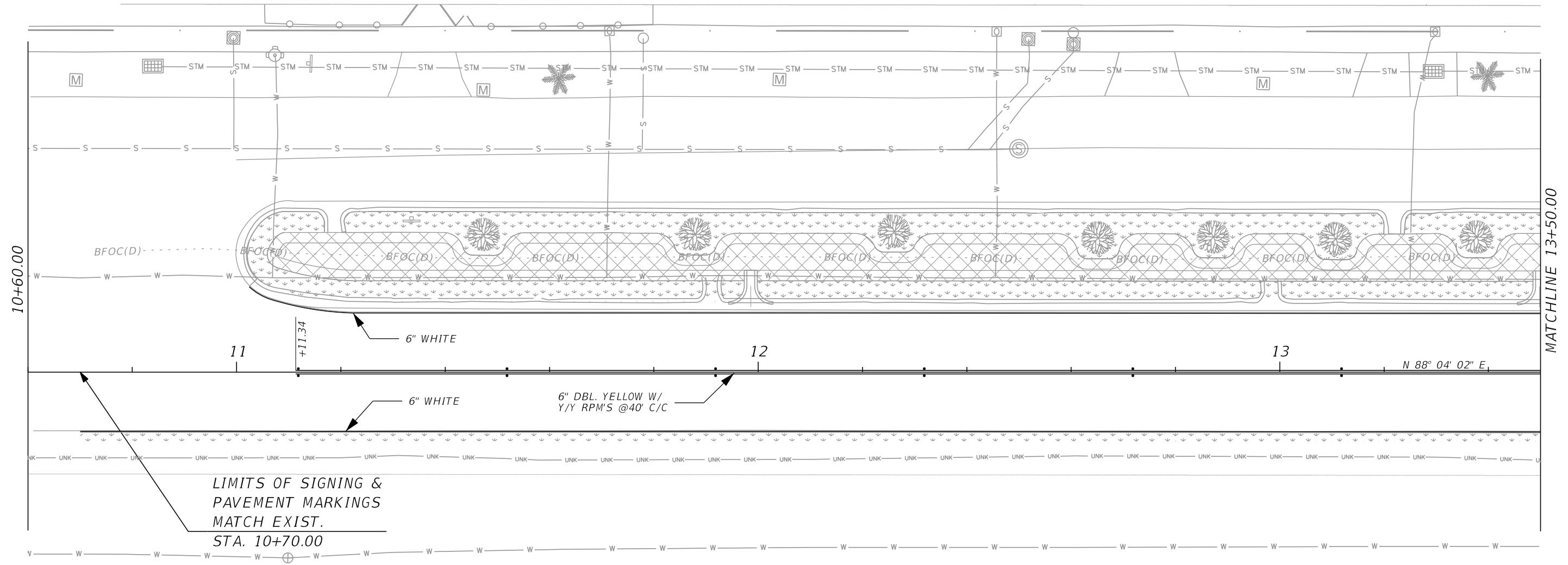
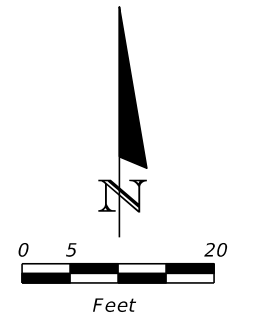

10+60.00

MATCHLINE 13+50.00

LIMITS OF SIGNING &  
PAVEMENT MARKINGS  
MATCH EXIST.  
STA. 10+70.00

REVISIONS					
DATE	BY	DESCRIPTION	DATE	BY	DESCRIPTION

**R.J. Behar & Company, Inc.**  
Engineers • Planners  
6861 S.W. 196 AVENUE, SUITE 302  
PEMBROKE PINES, FL 33332  
PAOLA RIVEROS, P.E. LICENSE NO. 74249

<b>CITY OF WEST PARK</b>	
PROJECT NAME	RJB PROJECT NO.
Countyline RD	23029

**SIGNING & PAVEMENT  
MARKING PLAN**

SHEET NO.  
14

THE OFFICIAL RECORD OF THIS SHEET IS THE ELECTRONIC FILE DIGITALLY SIGNED AND SEALED UNDER RULE 61G15-23.004, F.A.C.

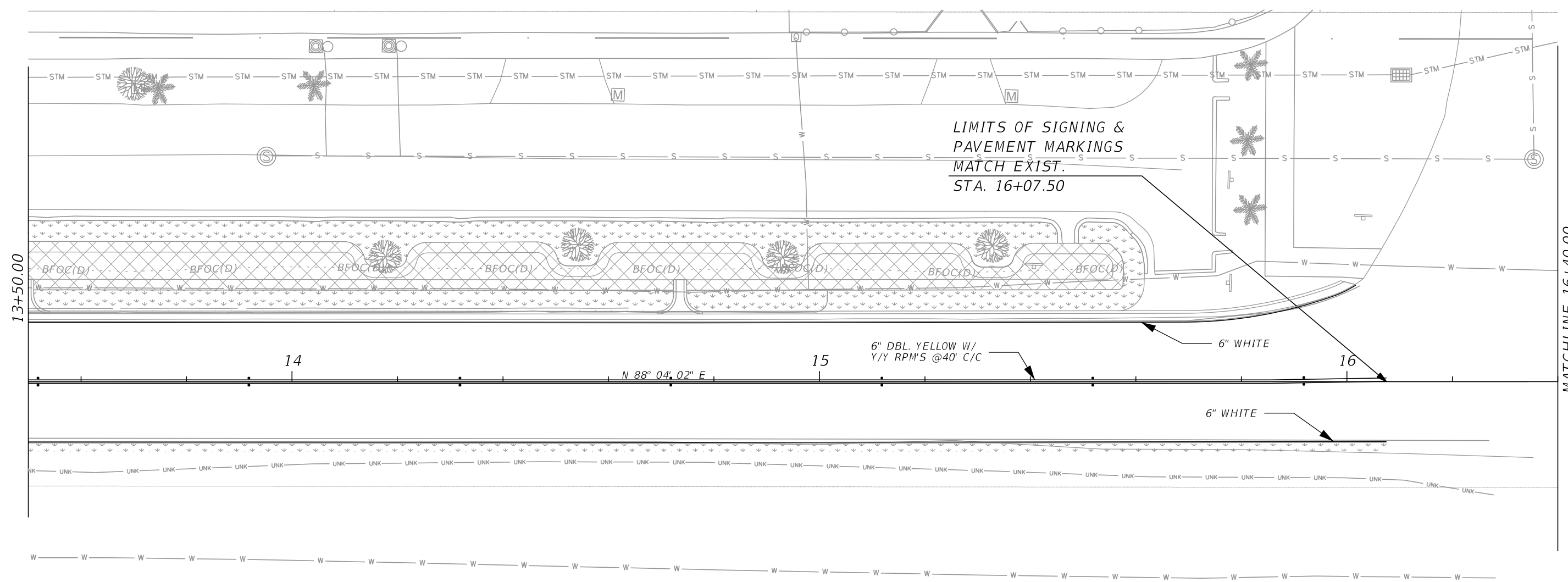
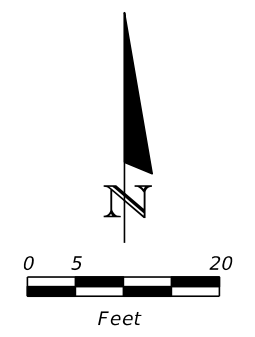

MATCHLINE 16+40.00

THE OFFICIAL RECORD OF THIS SHEET IS THE ELECTRONIC FILE DIGITALLY SIGNED AND SEALED UNDER RULE 61G15-23.004, F.A.C.

REVISIONS						<b>R.J. Behar &amp; Company, Inc.</b> Engineers • Planners 6861 S.W. 196 AVENUE, SUITE 302 PEMBROKE PINES, FL 33332 PAOLA RIVEROS, P.E. LICENSE NO. 74249	<b>CITY OF WEST PARK</b>		<b>SIGNING &amp; PAVEMENT MARKING PLAN</b>	SHEET NO.
DATE	BY	DESCRIPTION	DATE	BY	DESCRIPTION		PROJECT NAME	RJB PROJECT NO.		15
						Countyline RD	23029			

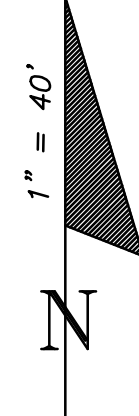

SW 32ND BLVD.

- LEGEND:**
- EXISTING TREE / PALM (PROTECT AT EXISTING LOCATION)
  - BIOSWALE PLANT MIX (SEE DETAIL)

INFORMATIONAL  
SIGNS

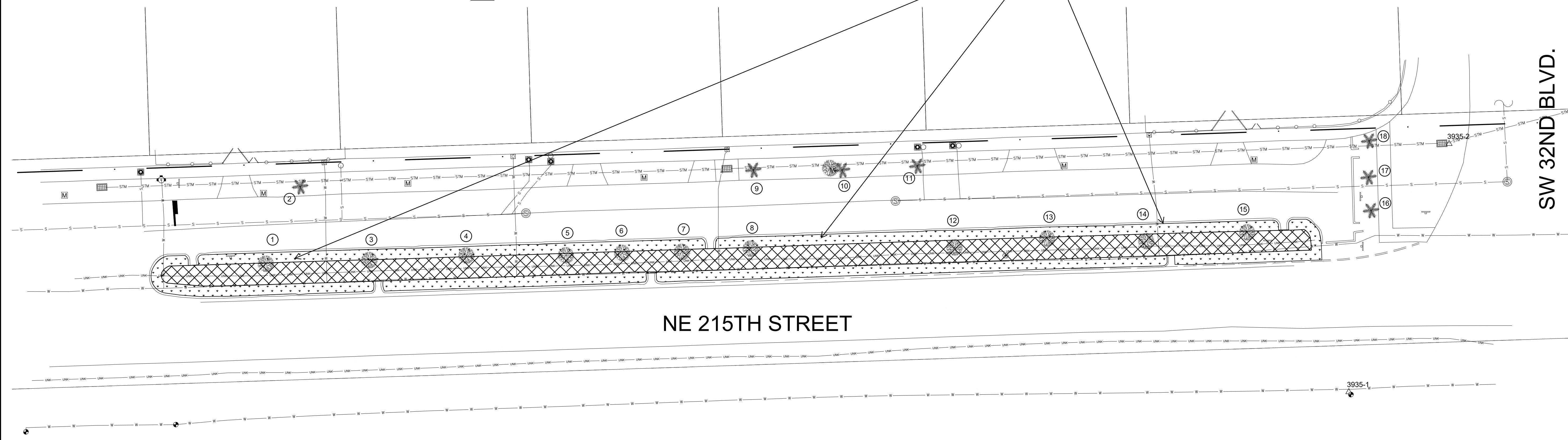

NE 215TH STREET

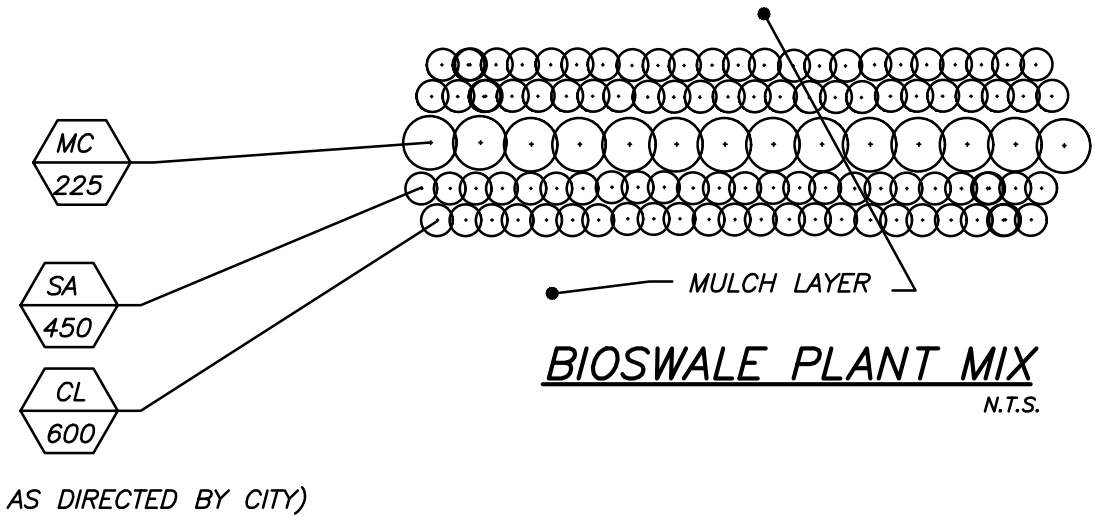
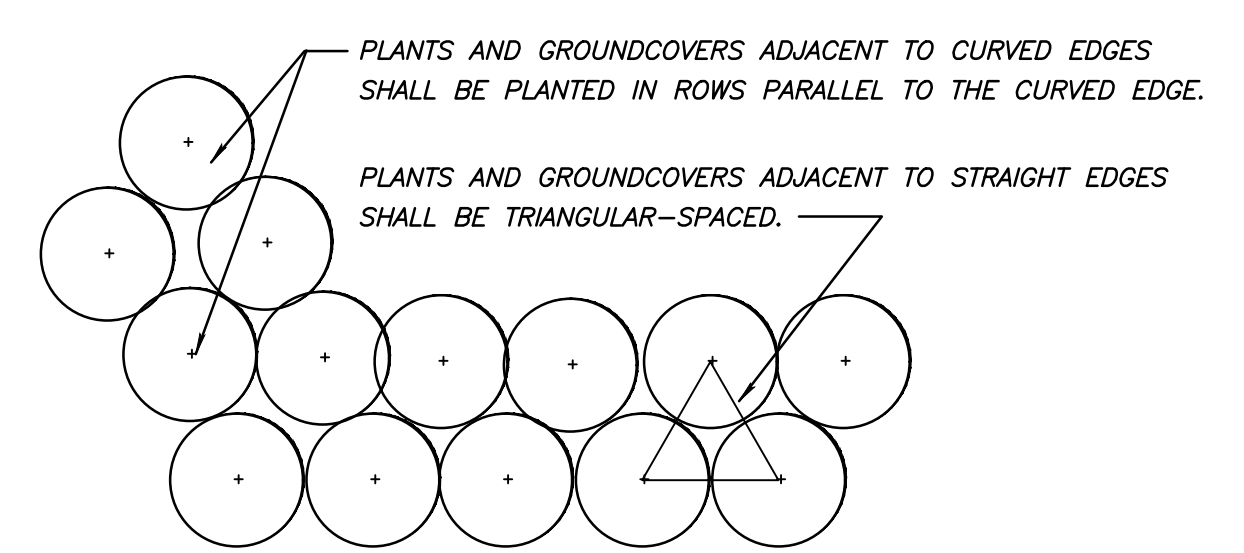

**PLANT INSTALLATION DETAIL**  
N.T.S.

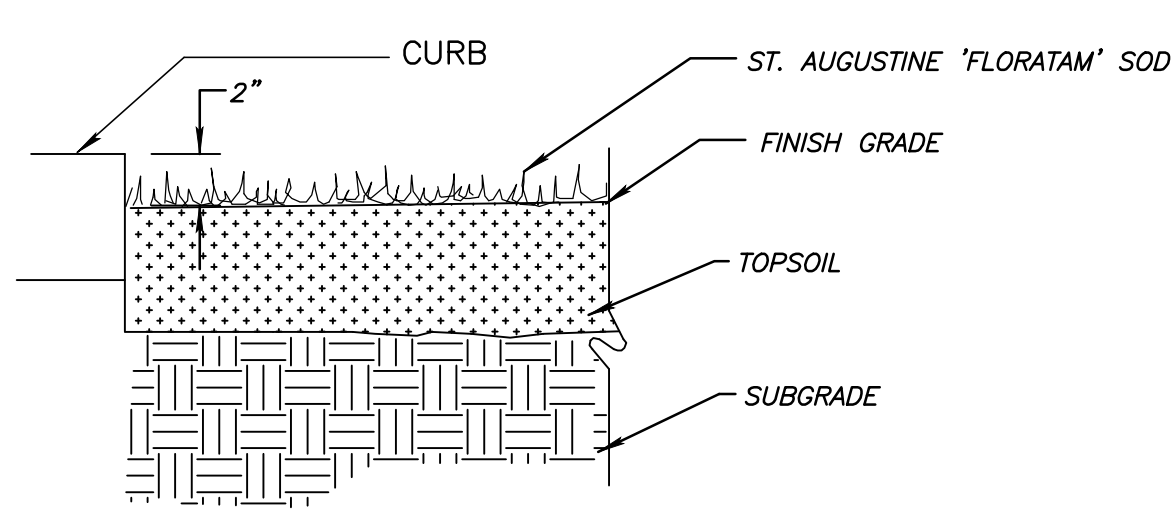

**SOD PLACEMENT DETAIL**  
N.T.S.

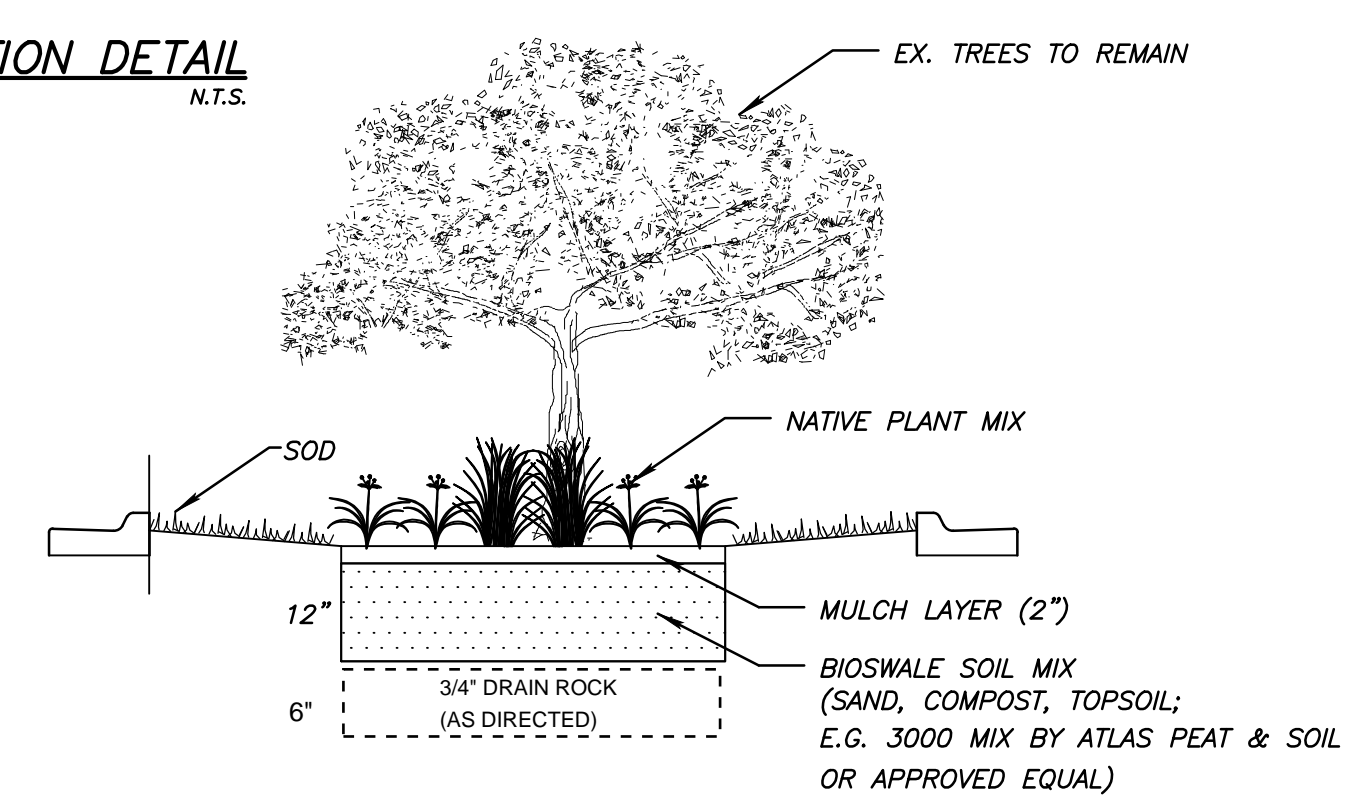

**BIOSWALE DETAIL**  
N.T.S.

**NURSERY STOCK SCHEDULE**

KEY	BOTANICAL NAME	COMMON NAME	NATIVE	WATER	QUANTITY	SIZE
CL	<i>Coreopsis leavenworthii</i>	COMMON TICKSEED	YES	LOW	600	1 GAL., 18"OC,
SA	<i>Sisyrinchium angustifolium</i>	BLUE-EYED GRASS	YES	LOW	450	1 GAL, 24"OC
MC	<i>Muhlenbergia capillaris</i>	MUHLY GRASS	YES	LOW	225	3 GAL, 24"OC
		ST. AUGUSTINE FLORATAM				SOLID SOD

**GENERAL PLANTING NOTES**

- ALL PLANT MATERIAL SHALL BE FLORIDA NO. 1, AS SPECIFIED IN THE GRADES AND STANDARDS FOR NURSERY PLANTS, 2nd EDITION, FEBRUARY 1998 (W/UPDATES MAY 2005) - UNLESS OTHERWISE NOTED.
- ALL PLANT MATERIAL SHALL MEET OR EXCEED THE SIZE REQUIREMENTS AS SPECIFIED IN THE PLANT LIST. NO SUBSTITUTIONS SHALL BE ACCEPTED WITHOUT APPROVAL BY THE OWNER AND/OR THEIR REPRESENTATIVES.
- CONTRACTOR IS RESPONSIBLE FOR VERIFYING ALL UNDERGROUND AND OVERHEAD UTILITIES AND OBTAINING THE NECESSARY CLEARANCES PRIOR TO PLANTING.
- ALL AREAS TO RECEIVE PLANTING SHALL BE PREPARED WITH PLANTING SOIL.
- ALL PLANTING AREAS SHALL BE FREE OF WEEDS. CYPRESS MULCH SHALL NOT BE USED.
- NEW SOD, SHRUBS AND GROUNDCOVERS SHALL BE FERTILIZED IN ACCORDANCE WITH MANUFACTURER'S RECOMMENDATIONS.
- ALL NEW PLANT MATERIAL SHALL BE WATERED IMMEDIATELY AFTER PLANTING. WATERING SHALL BE IN ACCORDANCE WITH RECOMMENDED SCHEDULE FOR AT LEAST 60 DAYS.
- ALL PLANTS SHALL BE GUARANTEED FOR A PERIOD OF ONE (1) YEAR FROM THE TIME OF FINAL ACCEPTANCE.
- SOD SHALL BE GUARANTEED FOR A PERIOD OF 90 DAYS FROM THE TIME OF FINAL ACCEPTANCE.

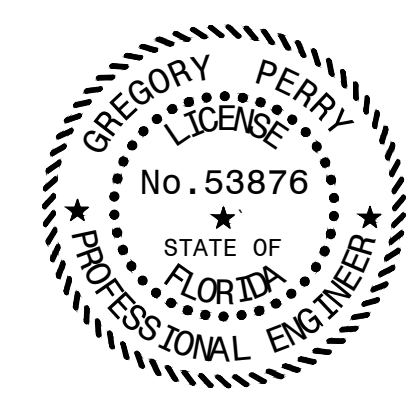

REVISIONS					
DATE	BY	DESCRIPTION	DATE	BY	DESCRIPTION

CITY OF WEST PARK

DESIGNED BY	NAME	DATE	DRAWN BY	NAME	DATE
GP	GP	07/14/23	GP	GP	07/14/23
CHECKED BY	NAME	DATE	CHECKED BY	NAME	DATE
GP	GP	07/14/23	GP	GP	07/14/23

SUPERVISED BY: GREGORY PERRY, P.E.

COUNTYLINE ROAD IMPROVEMENTS  
PHASE 1  
NE 215 ST  
WEST PARK, FLORIDA 33023

BIOSWALE PLAN

7/13/2023 11:07:52 AM 613767  
 D:\N\Arehna\Projects\2023\B-23-037 - City of West Park\RPT\BRD01.dgn



REVISIONS			
DATE	DESCRIPTION	DATE	DESCRIPTION

ENGINEER OF RECORD  
 ANDY TAO, P.E.  
 LICENSE NUMBER: 88520  
 AREHNA ENGINEERING, INC.  
 12296 WILES ROAD  
 CORAL SPRINGS, FL 33076

CITY OF WEST PARK		
ROAD	COUNTY	PROJECT NUMBER
COUNTY LINE RD	BROWARD	-

*BORING LOCATION PLAN*

SHEET NO.  
 GR-1

THE OFFICIAL RECORD OF THIS SHEET IS THE ELECTRONIC FILE DIGITALLY SIGNED AND SEALED UNDER RULE 61G15-23.004, F.A.C.

Bore # RB-01  
Reference CL COUNTY LINE RD  
Station 11+69  
Offset 5  
Latitude 25.9735978  
Longitude -80.1764635  
Date 6/5/2023  
Driller A. MILAN  
Hammer Auto  
Rig CME 45

Bore # RB-02  
Reference CL COUNTY LINE RD  
Station 13+45  
Offset -8  
Latitude 25.9736464  
Longitude -80.1759305  
Date 6/5/2023  
Driller A. MILAN  
Hammer Auto  
Rig CME 45

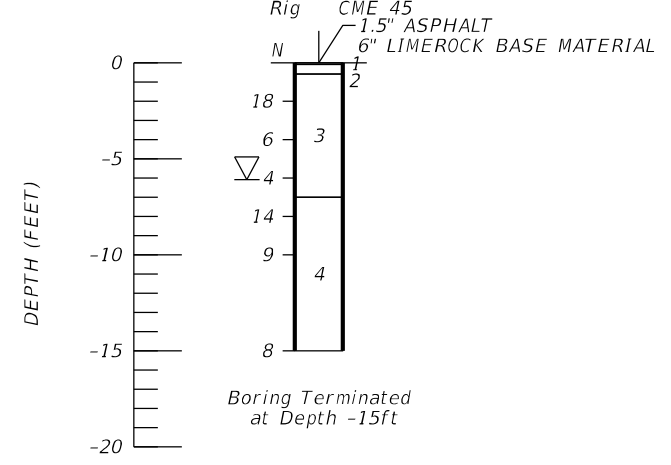

Boring Terminated  
at Depth -15ft

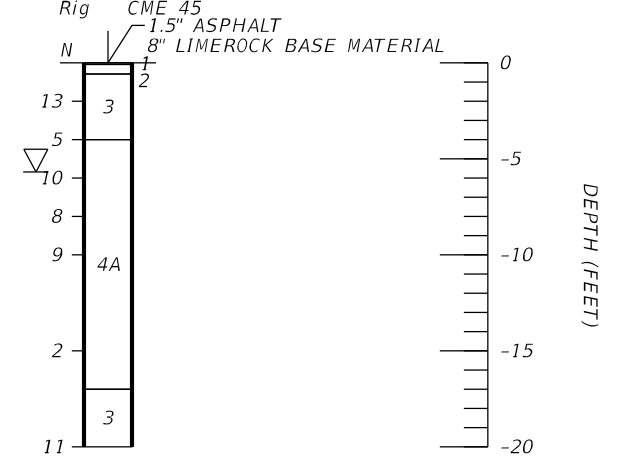

Boring Terminated  
at Depth -20ft  
Casing Length 20ft

**LEGEND**

- 1. ASPHALT
  - 2. LIMEROCK BASE (A-1-b)
  - 3. GRAY TO BROWN FINE SAND (A-3)
  - 4. TAN SANDY LIMESTONE
  - A WITH FEW SHELLS
  - A-3 AASHTO SOIL CLASSIFICATION GROUP SYMBOL AS DETERMINED BY VISUAL REVIEW AND/OR LABORATORY TESTING
  - ▽ GROUNDWATER TABLE
  - N NUMBERS TO THE LEFT OF BORINGS INDICATE SPT VALUE FOR 12 INCHES OF PENETRATION (UNLESS OTHERWISE NOTED).
  - | CASING
- AREHNA PROJECT NO. B-23-037

REVISIONS				ENGINEER OF RECORD		CITY OF WEST PARK			SHEET NO.
DATE	DESCRIPTION	DATE	DESCRIPTION	ANDY TAO, P.E. LICENSE NUMBER: 88520 AREHNA ENGINEERING, INC. 12296 WILES ROAD CORAL SPRINGS, FL 33076		ROAD	COUNTY	PROJECT NUMBER	
								COUNTY LINE RD	BROWARD

*Roadway Soil Profiles*

DATE OF SURVEY: JUNE 2023  
 SURVEY MADE BY: AREHNA ENGINEERING, INC.  
 SUBMITTED BY: ANDY TAO, P.E.

**CITY OF WEST PARK**

DISTRICT: N/A  
 ROAD NO.: COUNTY LINE RD  
 COUNTY: BROWARD

PROJECT NUMBER:  
 PROJECT NAME: COUNTY LINE ROAD

**CROSS SECTION SOIL SURVEY FOR THE DESIGN OF ROADS**

SURVEY BEGINS STA. : 10+00.00 SURVEY ENDS STA. : 16+64.68

REFERENCE: CL COUNTY LINE RD

STRATUM NO.	ORGANIC CONTENT		MOISTURE CONTENT		SIEVE ANALYSIS RESULTS PERCENT PASS (%)					ATTERBERG LIMITS (%)			DESCRIPTION	CORROSION TEST RESULTS					
	NO. OF TESTS	% ORGANIC	NO. OF TESTS	MOISTURE CONTENT	NO. OF TESTS	10 MESH	40 MESH	60 MESH	100 MESH	200 MESH	NO. OF TESTS	LIQUID LIMIT		PLASTIC INDEX	AASHTO GROUP	NO. OF TESTS	RESISTIVITY ohm-cm	CHLORIDES ppm	SULFATES ppm
1	--	--	--	--	--	--	--	--	--	--	--	--	--	ASPHALT	--	--	--	--	--
2	--	--	--	--	--	--	--	--	--	--	--	--	--	A-1-b LIMEROCK BASE	--	--	--	--	--
3	1	1	2	5-11	2	100	88	8	4	1-3	--	--	--	A-3 GRAY TO BROWN FINE SAND	--	--	--	--	--
4	--	--	--	--	--	--	--	--	--	--	--	--	--	TAN SANDY LIMESTONE	--	--	--	--	--

EMBANKMENT AND SUBGRADE MATERIAL

STRATA BOUNDARIES ARE APPROXIMATE. MAKE FINAL CHECK AFTER GRADING.

- ▽ GROUNDWATER TABLE
- A WITH FEW SHELLS

NOTES:

- THE MATERIAL FROM STRATUM 1 IS THE EXISTING ASPHALT PAVEMENT SECTION. THE ASPHALT LAYER SHALL BE REMOVED WHEN REQUIRED BY THE PROJECT SPECIFICATIONS.
- THE MATERIAL FROM STRATUM 3 (A-3) IS SELECT (S) AND APPEARS SATISFACTORY FOR USE IN THE EMBANKMENT WHEN UTILIZED IN ACCORDANCE WITH STANDARD PLANS, INDEX 120-001.
- THE MATERIAL FROM STRATUM 4 CORRESPONDS TO A LIMESTONE FORMATION THAT TYPICALLY OFFERS HIGH RESISTANCE TO EXCAVATION. SPECIAL EQUIPMENT AND BREAKING TOOLS MAY BE REQUIRED TO EXCAVATE IT.

7/13/2023 11:07:56 AM 613767 D:\Arehna\Projects\2023\B-23-037 - City of West Park\RPT\BRD01.dgn

THE OFFICIAL RECORD OF THIS SHEET IS THE ELECTRONIC FILE DIGITALLY SIGNED AND SEALED UNDER RULE 61G15-23.004, F.A.C.

REVISIONS				ENGINEER OF RECORD			CITY OF WEST PARK			SHEET NO.
DATE	DESCRIPTION	DATE	DESCRIPTION	ANDY TAO, P.E. LICENSE NUMBER: 88520 AREHNA ENGINEERING, INC. 12296 WILES ROAD CORAL SPRINGS, FL 33076			ROAD	COUNTY	PROJECT NUMBER	
							COUNTY LINE RD	BROWARD	-	
							GR-3			